

# CLK series

## Main features

### Adaptor CLK 04 SC

The new adaptor **CLK 04 SC** enables use of **fibre optic SC contacts**, up to 4 SC contacts per connector, for indoor or outdoor heavy duty industrial applications, with ILME connector enclosures size "21.21" series **CKA** (IP66/IP67, metallic, both C-TYPE, grey-painted, for normal environments, and W-TYPE black-painted, for aggressive environments, only the hood models provided with sealing gasket), series **CGK/ MGK** (IP66/IP68, metallic, either Pg or metric-threaded cable outlet) and series **CK** (IP66/IP67, insulating, only the hood models provided with sealing gasket).

The **fibre optic SC contacts** (genderless, to be purchased separately) are available both for multi-mode fibres (50/125 µm or 62,5/125 µm) and single-mode fibre (9/125 µm). The fibre optic SC contacts are also available for the hard-clad silica (HCS) or polymer-clad fibre (PCF) 200/230 µm fibre optic cables and for the less demanding, with shorter transmission distance covered, but more cost effective POF Ø 1 mm applications, available with crimp technique version (crimping tool required).

### NOTE

Due to the higher skill and training required to produce an effectively performing fibre optic junction for a single-mode type fibre-optic cable than for a multi-mode one, dedicated contacts for single-mode are available only upon request. Contact our Commercial Department for a quotation. It is more practical in such case to equip the CLK 04 SC adaptor with ready-to-use fibre optic patch cords. Quick assembly technique version (tool-less) for POF Ø 1 mm cables are also available only upon request, please send inquiry to our Commercial Department.

The female adaptor inserts are provided with 4 **ceramic** (zirconia) type **split alignment sleeves**, for minimal insertion loss (e.g. critical network connections) and best suitable for single-mode F/O cable connections. As optional accessory, **metallic** (phosphor bronze) **split alignment sleeves** are also available for more durable (less prone to cracking) applications, but less demanding precision alignment, thus most suitable for multi-mode fibre applications.

Part No. of adaptor inserts		CLK 04 SC
No. of seats/poles	seats for optical contacts	2
ambient temperature limit (°C)	min	-40
	max	+70
degree of protection	with enclosures (according to type)	IP66/IP67, IP66/IP68, IP69K
conductor connections		crimp
mechanical endurance (rating cycles)		≥ 500
self-extinguishing capacity UL 94		V0

## FEMALE

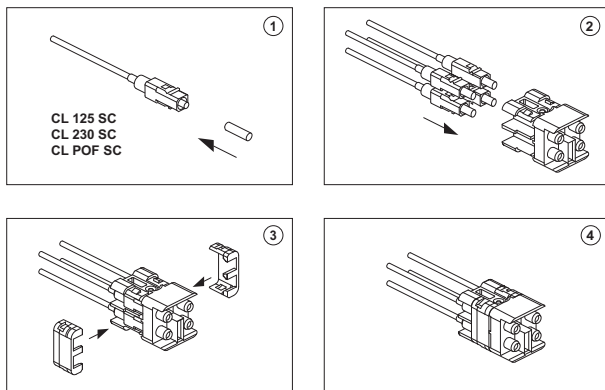

## MALE

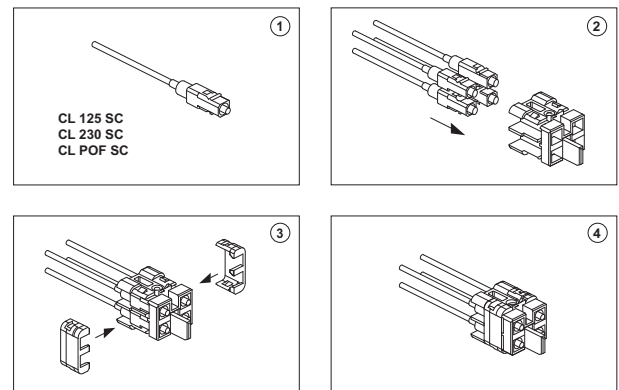

enclosures: page:  
size "21.21"

**insulating type** ..... 526 - 527  
(CK IN, CKG/MKG VN)

**metallic type**  
(CKAX I, CKAX/MKAX IAP/AP/VG) 223 and 528  
(CKAG/MKAG V) ..... 529

**IP68** ..... 416 - 418  
(CGK I, CGK/MGK IAP, CGK/MGK V)

### adaptor insert for SC connectors



**NEW**

### crimp FO contacts

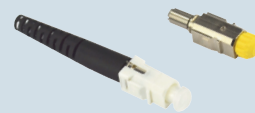

**NEW**

description	part No.	part No.
-------------	----------	----------

adaptor insert with seats for 4 SC contacts  
- female insert, with ceramic sleeve  
- female insert, with metallic sleeve  
- male insert

**CLK 04 SCF**  
**CLK 04 SCF-H**  
**CLK 04 SCM**

SC contact for GI FIBRE 50/125 µm or 62.5/125 µm  
SC contact for 1 mm Ø POF

**CL 125 SC**  
**CL POF SC**

- adaptor insert fitted with fixing screw and gasket, suitable for installation in enclosures  
- adaptor insert designed to be used with SC contacts  
- SC contact for SI FIBRE (HCS®) 200/230 µm: **CL 230 SC** (on request)

- base equipment for SC contact GI FIBRE:  
**CLKZ 125 SC**  
If this application is required, please contact ILME SpA.

dimensions in mm

dimensions in mm

- supplementary set for POF:  
**CLKZ POF**  
(to be ordered with CLKZ 125 SC)  
If this application is required, please contact ILME SpA.

**CLK 04 SCF, CLK 04 SCM**

**CL 125 SC**

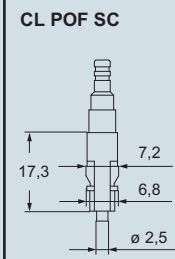
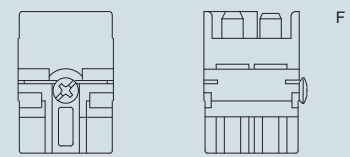
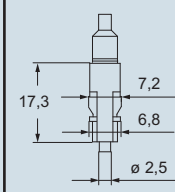
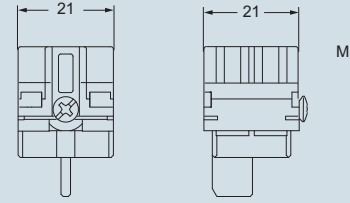

contacts side (front view)

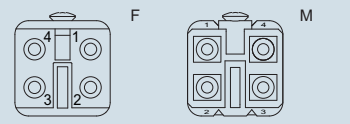

dimensions shown are not binding and may be changed without notice

- characteristics according to EN 61984:
- CX 08 B shielded connector
- 5A 50V 0,8kV 3**
- contact resistance
- CX 08 B shielded connector:  $\leq 4 \text{ m}\Omega$
- max.  $\varnothing$  of insulation for contacts CI series (CX 08 B shielded connector): 2,4 mm
- for crimp 5A contacts CI series using: CIPZ D crimping tool + CIP D turret head
- insertion / removal tool contacts CI series: part No CIES

shielded connectors



5A crimp contacts, gold plated



description	part No.	part No.
shielded BUS multi axial connectors, 8 poles + shield - female insert, 8 contact seats 5A (CIF) + shield - male insert, 8 contact seats 5A (CIM) + shield	<b>CX 08 BF</b> <b>CX 08 BM</b>	
5A female crimp contacts 0,08-0,21 mm <sup>2</sup> AWG 28-24 0,13-0,33 mm <sup>2</sup> AWG 26-22 0,33-0,52 mm <sup>2</sup> AWG 22-20		<b>CIFD 0.2</b> <b>CIFD 0.3</b> <b>CIFD 0.5</b>
5A male crimp contacts 0,08-0,21 mm <sup>2</sup> AWG 28-24 0,13-0,33 mm <sup>2</sup> AWG 26-22 0,33-0,52 mm <sup>2</sup> AWG 22-20		<b>CIMD 0.2</b> <b>CIMD 0.3</b> <b>CIMD 0.5</b>

gold plated

dimensions in mm

**CX 08 BF, CX 08 BM**

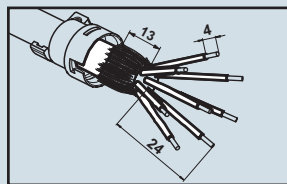
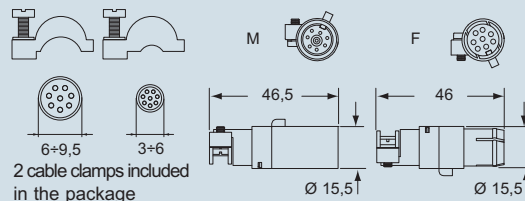

**CIF and CIM**

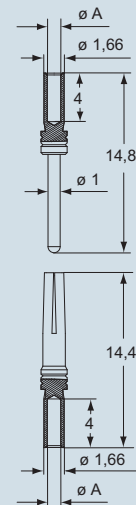

**CIF, CIM contacts**

conductor section mm <sup>2</sup>	conductor slot $\varnothing A$ (mm)	conductors stripping length (mm)
0,08-0,21	0,64	4
0,13-0,33	0,90	4
0,33-0,52	1,12	4

dimensions shown are not binding and may be changed without notice

- characteristics according to EN 61984:

CX 01 BC shielded connector

**16A 50V 0,8kV 3**

- for information on the crimping of contacts series CC (CX 01 BC shielded connector) and on the insertion / removal tools, see the section related to crimping tools (16A contacts, CCF and CCM series) on pages 534, 538, 544, 546, 548

- contact resistance

CX 01 BC shielded connector:  $\leq 1\text{ m}\Omega$

- CX 01 BC shielded connector for **cable with a typical impedance of 50  $\Omega$**

shielded connectors



16A crimp contacts, silver or gold plated



description

part No.

part No.

part No.

shielded BUS coaxial connectors, 1 pole + shield  
 - female insert, 1 contact seat 16A (CCF) + shield  
 - male insert, 1 contact seat 16A (CCM) + shield

**CX 01 BCF**  
**CX 01 BCM**

16A female contacts

0,14-0,37 mm <sup>2</sup>	AWG 26-22	three grooves
0,5 mm <sup>2</sup>	AWG 20	with no grooves
0,75 mm <sup>2</sup>	AWG 18	one groove (back side)
1 mm <sup>2</sup>	AWG 18	one groove
1,5 mm <sup>2</sup>	AWG 16	two grooves
2,5 mm <sup>2</sup>	AWG 14	three grooves
3 mm <sup>2</sup>	AWG 12	one wide groove
4 mm <sup>2</sup>	AWG 12	with no grooves

16A male contacts

0,14-0,37 mm <sup>2</sup>	AWG 26-22	three grooves
0,5 mm <sup>2</sup>	AWG 20	with no grooves
0,75 mm <sup>2</sup>	AWG 18	one groove (back side)
1 mm <sup>2</sup>	AWG 18	one groove
1,5 mm <sup>2</sup>	AWG 16	two grooves
2,5 mm <sup>2</sup>	AWG 14	three grooves
3 mm <sup>2</sup>	AWG 12	one wide groove
4 mm <sup>2</sup>	AWG 12	with no grooves

**silver plated**

CCFA 0.3
CCFA 0.5
CCFA 0.7
CCFA 1.0
CCFA 1.5
CCFA 2.5
CCFA 3.0
CCFA 4.0

**gold plated 1)**

CCFD 0.3
CCFD 0.5
CCFD 0.7
CCFD 1.0
CCFD 1.5
CCFD 2.5
CCFD 3.0
CCFD 4.0

CCMA 0.3
CCMA 0.5
CCMA 0.7
CCMA 1.0
CCMA 1.5
CCMA 2.5
CCMA 3.0
CCMA 4.0

CCMD 0.3
CCMD 0.5
CCMD 0.7
CCMD 1.0
CCMD 1.5
CCMD 2.5
CCMD 3.0
CCMD 4.0

dimensions in mm

CX 01 BCF, CX 01 BCM

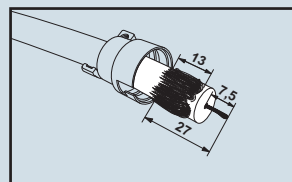
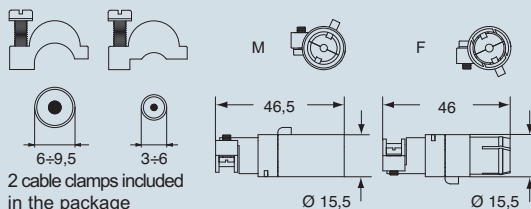

CCF and CCM

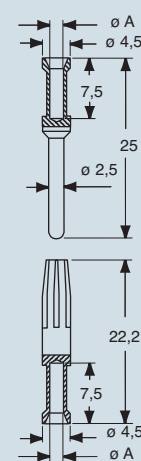

CCF and CCM contacts

conductor section	conductor slot	conductors stripping length
mm <sup>2</sup>	$\phi A$ (mm)	(mm)
0.14-0.37	0.9	7.5
0.5	1.1	7.5
0.75	1.3	7.5
1.0	1.45	7.5
1.5	1.8	7.5
2.5	2.2	7.5
3	2.55	7.5
4	2.85	7.5

1) basic or high thickness gold plating page 481

dimensions shown are not binding and may be changed without notice