

inserts:	page:
CDC	10, 16 poles + ⊕ 99 and 101
CCE ..	6, 10, 16, 24, 32, 48 poles + ⊕ 110-115
CQE ..	10, 18, 32, 46, 64, 92 poles + ⊕ 138-143
CQEE	40, 64 poles + ⊕ 146-147
CMCE .	3+2, 6+2, 10+2, 16+2, 12+4, 20+4, 32+4 .. poles + ⊕ 148-160
CQ	5 poles + ⊕ 166
CX	8/24 poles + ⊕ 169
CX	6/6 poles + ⊕ 175
MIXO	(16A) 189-199

**constantan (Cu Ni)
crimp contacts**



**iron (Fe)
crimp contacts**



description	part No.	part No.
16A, 0,3 mm ² , AWG 22 female contacts	CCFC 0.3	CCFF 0.3
16A, 0,3 mm ² , AWG 22 male contacts	CCMC 0.3	CCMF 0.3
16A, 0,5 mm ² , AWG 20 female contacts	CCFC 0.5	CCFF 0.5
16A, 0,5 mm ² , AWG 20 male contacts	CCMC 0.5	CCMF 0.5

Note:
A mixed combination of standard Iron, Constantan and silver and gold plated contacts can be fitted in the same insert.

- for crimp contacts, see the crimp tool section (16A, CCF and CCM series contacts) pages 534, 538, 544, 546, 548
- for thermocouples compliant with DIN IEC 584 type J
- contact resistance ≤ 1 Ohm

dimensions in mm

CCF and CCM

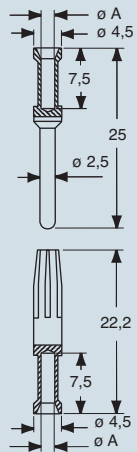

CCF and CCM contacts

conductor section mm ²	conductor slot ø A (mm)	conductors stripping length (mm)
0,3	1,1	7,5
0,5	1,1	7,5

dimensions in mm

CCF and CCM

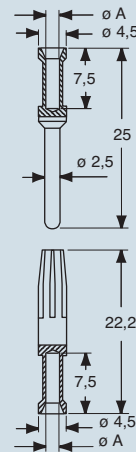

CCF and CCM contacts

conductor section mm ²	conductor slot ø A (mm)	conductors stripping length (mm)
0,3	1,1	7,5
0,5	1,1	7,5

dimensions shown are not binding and may be changed without notice

insert:	page:
CD (10A)	53-61
CDD (10A)	67-74
CQ (10A)	165 and 168
CX 8/24 (16A/10A)	169
CX 6/36 (10A)	170
CX 12/2 (10A)	171
MIXO (10A)	185-203

**10A crimp contacts
high thickness gold plating**



NEW

**10A crimp contacts
basic gold plated**



NEW

description	part No.	part No.
10A female contacts		
0,14-0,37 mm ² AWG 26-22 identification No. 1	CDF2D 0.3	CDFJD 0.3
0,5 mm ² AWG 20 identification No. 2	CDF2D 0.5	CDFJD 0.5
0,75 mm ² AWG 18 identification No. ②	CDF2D 0.7	CDFJD 0.7
1,0 mm ² AWG 18 identification No. 3	CDF2D 1.0	CDFJD 1.0
1,5 mm ² AWG 16 identification No. 4	CDF2D 1.5	CDFJD 1.5
2,5 mm ² AWG 14 identification No. 5	CDF2D 2.5	CDFJD 2.5
10A male contacts		
0,14-0,37 mm ² AWG 26-22 identification No. 1	CDM2D 0.3	CDMJJD 0.3
0,5 mm ² AWG 20 identification No. 2	CDM2D 0.5	CDMJJD 0.5
0,75 mm ² AWG 18 identification No. ②	CDM2D 0.7	CDMJJD 0.7
1,0 mm ² AWG 18 identification No. 3	CDM2D 1.0	CDMJJD 1.0
1,5 mm ² AWG 16 identification No. 4	CDM2D 1.5	CDMJJD 1.5
2,5 mm ² AWG 14 identification No. 5	CDM2D 2.5	CDMJJD 2.5

gold plated

gold plated

The new gold plated contacts provide:
 - corrosion resistance (according to EN 60068)
 - mechanical life: ≥ 500 coupling cycles
 - in compliance with EN 61984:2010-4, IEC 60512, EN 60352-2: 1994
 - compliant to directive RoHS
 - contact resistance: ≤ 3 mΩ
 - certifications: UL

dimensions in mm

CDF2 and CDM2

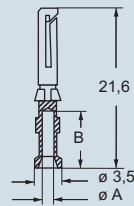
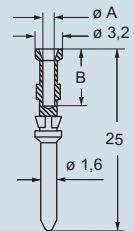

contacts CDF2 and CDM2

conductor section mm ²	conductor slot ø A (mm)	conductors stripping length B (mm)
0,14-0,37	0,9	8
0,5	1,1	8
0,75	1,3	8
1,0	1,45	8
1,5	1,8	8
2,5	2,2	6

dimensions in mm

CDFJ and CDMJ

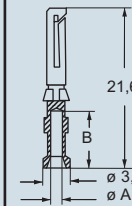
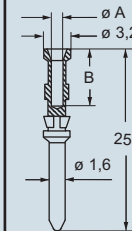

contacts CDFJ and CDMJ

conductor section mm ²	conductor slot ø A (mm)	conductors stripping length B (mm)
0,14-0,37	0,9	8
0,5	1,1	8
0,75	1,3	8
1,0	1,45	8
1,5	1,8	8
2,5	2,2	6

dimensions shown are not binding and may be changed without notice

insert:	page:
CDC (16A)	99-103
CCE (16A)	110-115
CQE (16A)	138-143
CQEE (16A)	146-147
CMCE (16A)	148-160
CQ (16A)	166-167
CX 8/24 (16A/10A)	169
CX 6/6 (16A/10A)	175
MIXO (16A)	189-199

**16A crimp contacts
high thickness gold plating**



NEW

**16A crimp contacts
basic gold plated**



NEW

description	part No.	part No.
<p>16A female contacts</p> <p>0,14-0,37 mm² AWG 26-22 one groove</p> <p>0,5 mm² AWG 20 with no grooves</p> <p>0,75 mm² AWG 18 one groove (back side)</p> <p>1,0 mm² AWG 18 one groove</p> <p>1,5 mm² AWG 16 two grooves</p> <p>2,5 mm² AWG 14 three grooves</p> <p>3,0 mm² AWG 12 one wide groove</p> <p>4,0 mm² AWG 12 with no grooves</p>	<p>CCF2D 0.3</p> <p>CCF2D 0.5</p> <p>CCF2D 0.7</p> <p>CCF2D 1.0</p> <p>CCF2D 1.5</p> <p>CCF2D 2.5</p> <p>CCF2D 3.0</p> <p>CCF2D 4.0</p>	<p>CCFJD 0.3</p> <p>CCFJD 0.5</p> <p>CCFJD 0.7</p> <p>CCFJD 1.0</p> <p>CCFJD 1.5</p> <p>CCFJD 2.5</p> <p>CCFJD 3.0</p> <p>CCFJD 4.0</p>
<p>16A male contacts</p> <p>0,14-0,37 mm² AWG 26-22 one groove</p> <p>0,5 mm² AWG 20 with no grooves</p> <p>0,75 mm² AWG 18 one groove (back side)</p> <p>1,0 mm² AWG 18 one groove</p> <p>1,5 mm² AWG 16 two grooves</p> <p>2,5 mm² AWG 14 three grooves</p> <p>3,0 mm² AWG 12 one wide groove</p> <p>4,0 mm² AWG 12 with no grooves</p>	<p>CCM2D 0.3</p> <p>CCM2D 0.5</p> <p>CCM2D 0.7</p> <p>CCM2D 1.0</p> <p>CCM2D 1.5</p> <p>CCM2D 2.5</p> <p>CCM2D 3.0</p> <p>CCM2D 4.0</p>	<p>CCMJD 0.3</p> <p>CCMJD 0.5</p> <p>CCMJD 0.7</p> <p>CCMJD 1.0</p> <p>CCMJD 1.5</p> <p>CCMJD 2.5</p> <p>CCMJD 3.0</p> <p>CCMJD 4.0</p>

The new gold plated contacts provide:

- corrosion resistance (according to EN 60068)
- mechanical life: ≥ 500 coupling cycles
- in compliance with EN 61984:2010-4, IEC 60512, EN 60352-2: 1994
- compliant to directive RoHS
- contact resistance: ≤ 1 mΩ
- certifications: UL

dimensions in mm

CCF2 and CCM2

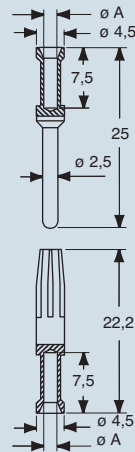

contacts CCF2 and CCM2

conductor section mm ²	conductor slot ø A (mm)	conductors stripping length B (mm)
0,14-0,37	0,9	7,5
0,5	1,1	7,5
0,75	1,3	7,5
1,0	1,45	7,5
1,5	1,8	7,5
2,5	2,2	7,5
3,0	2,55	7,5
4,0	2,85	7,5

dimensions in mm

CCFJ and CCMJ

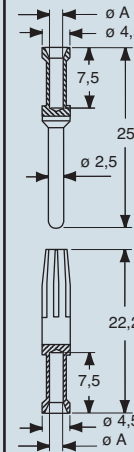

contacts CCFJ and CCMJ

conductor section mm ²	conductor slot ø A (mm)	conductors stripping length B (mm)
0,14-0,37	0,9	7,5
0,5	1,1	7,5
0,75	1,3	7,5
1,0	1,45	7,5
1,5	1,8	7,5
2,5	2,2	7,5
3,0	2,55	7,5
4,0	2,85	7,5

dimensions shown are not binding and may be changed without notice