



CH C-TYPE standard version

inserts		page:
CDD	42 poles + ⊕	78
CDS	18 poles + ⊕	-
CDSH	18 poles + ⊕	87
CNE	10 poles + ⊕	111
CSE	10 poles + ⊕	-
CSH	10 poles + ⊕	111
CSH S	10 poles + ⊕	123
CCE	10 poles + ⊕	131
CMSH	3+2 (aux) poles + ⊕	136
CMCE	3+2 (aux) poles + ⊕	137
CSS	10 poles + ⊕	149
CT, CTSE (16A) *)	10 poles + ⊕	161
CQE	18 poles + ⊕	169
CX	8/24 poles + ⊕	194
MIXO	3 modules	262 - 317

*) can be used only in bulkhead mounting housings

bulkhead mounting housings with 2 levers or 4 pegs



bulkhead mounting housings with single lever



description	part No.	part No.
with one or two levers	CHI 10	CHI 10 L
with pegs 1)	CHI 10 C	
with pegs and aluminum cover 1)	CHI 10 CS	
with pegs and plastic cover 1)	CHI 10 CP	
with lever and cover		CHI 10 LS

1) may be combined with enclosures:
- CHO/CAO 10 X and CHV/CAV 10 X
- MHO/MAO 10 X and MHV/MAV 10 X

panel cut-out for bulkhead mounting housings

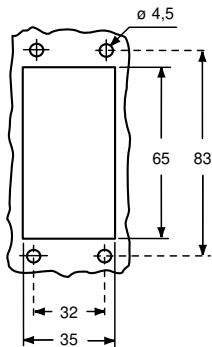

IMPORTANT NOTE: The enclosures ensure IP66/IP69 degree of protection (or IP65 for hinged cover versions) when mated and locked with the closing levers.
The cover (CS, CP) only ensures mechanical protection, but does not ensure IP65 degree of protection.

CR CLK
locking device for
CLASS locking levers
(page 666)



CAUS Type 4/4X/12
(except enclosures with plastic cover)



CHI ▲

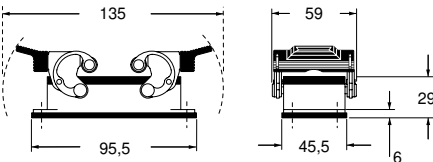

CHI C ▲

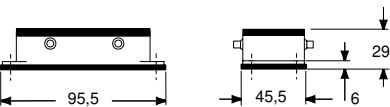

CHI CS/CP ●

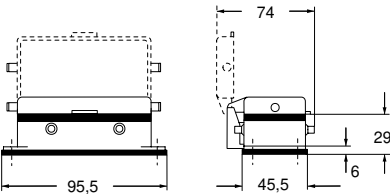

CHI L ▲

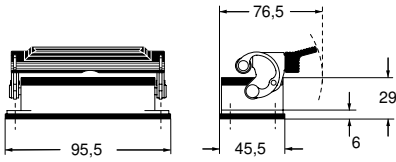

CHI LS ●

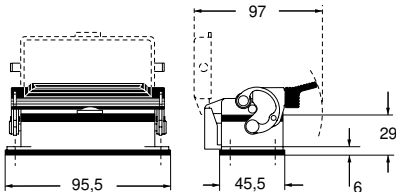

ANGLED VERSION
(page 450)



C-TYPE



CV - CVA and MV - MVA V-TYPE lever SIMPLEX self-closing covers

inserts		page:
CDD	42 poles + ⊕	78
CDS	18 poles + ⊕	-
CDSH	18 poles + ⊕	87
CNE	10 poles + ⊕	111
CSE	10 poles + ⊕	-
CSH	10 poles + ⊕	111
CSH S	10 poles + ⊕	123
CCE	10 poles + ⊕	131
CMSH	3+2 (aux) poles + ⊕	136
CMCE	3+2 (aux) poles + ⊕	137
CSS	10 poles + ⊕	149
CT, CTSE (16A) *)	10 poles + ⊕	161
CQE	18 poles + ⊕	169
CX	8/24 poles + ⊕	194
MIXO	3 modules	262 - 317

*) can be used only in bulkhead mounting housings

bulkhead mounting housings with stainless steel single lever



surface mounting housings with stainless steel single lever



description	part No.	part No.	entry Pg	part No.	entry M
with lever, gasket and cover in plastic	CVI 10 LSP				
with lever and cover		CVP 10 LSP16	16	MVP 10 LSP20	20
with lever and cover				MVP 10 LSP25	25
with lever and cover, high construction		CVAP 10LSP21	21	MVAP 10LSP25	25
with lever and cover, high construction		CVAP 10LSP29	29	MVAP 10LSP32	32
with lever and cover, high construction				MVAP 10LSP40	40

☑ The enclosures ensure IP65 degree of protection when mated and locked with the closing lever, or IP44 protection when not mated and locked with lever, thanks to the SIMPLEX self-closing cover.

panel cut-out for bulkhead mounting housings

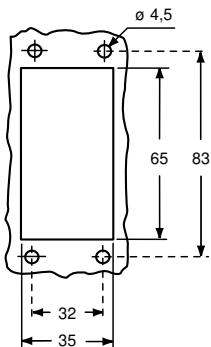

Hoods (from page 395)



CVI LSP

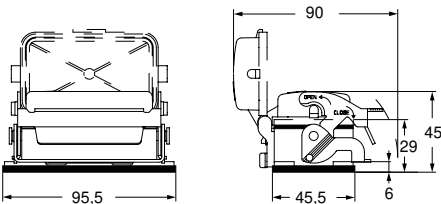

CVP - CVAP LSP and MVP - MVAP LSP

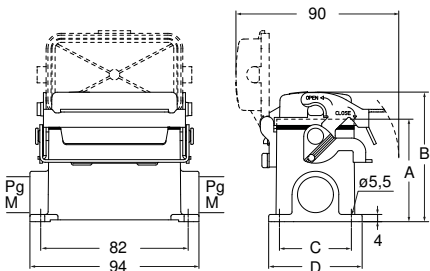

type	A	B	C	D
CVP / MVP 10 LSP	57	72	40	52
CVAP / MVAP 10 LSP	74	89	45	57

CEC® US Type 4/4X/12



CEC® US Type 4/4X/12 pending



CH - CA and MH - MA C-TYPE standard version

inserts

CDD	42 poles + ⊕	78
CDS	18 poles + ⊕	-
CDSH	18 poles + ⊕	87
CNE	10 poles + ⊕	111
CSE	10 poles + ⊕	-
CSH	10 poles + ⊕	111
CSH S	10 poles + ⊕	123
CCE	10 poles + ⊕	131
CMSH	3+2 (aux) poles + ⊕	136
CMCE	3+2 (aux) poles + ⊕	137
CSS	10 poles + ⊕	149
CQE	18 poles + ⊕	169
CX	8/24 poles + ⊕	194
MIXO	3 modules	262 - 317

page:

surface mounting housings
with 2 levers or 4 pegssurface mounting housings
with single lever

description	part No.	entry Pg	part No.	entry M	part No.	entry Pg	part No.	entry M
with lever/s	CHP 10	16	MHP 10.20	20	CHP 10 L	16	MHP 10 L20	20
with lever/s	CHP 10.2	16 x 2	MHP 10.220	20 x 2	CHP 10 L2	16 x 2	MHP 10 L220	20 x 2
with levers, high construction ¹⁾			MAP 10.25	25				
with levers, high construction ¹⁾			MAP 10.225	25 x 2				
with lever/s, high construction	CAP 10.21	21	MAP 10.32	32	CAP 10 L	21	MAP 10 L32	32
with lever/s, high construction	CAP 10.221	21 x 2	MAP 10.232	32 x 2	CAP 10 L2	21 x 2	MAP 10 L232	32 x 2
with lever/s, high construction	CAP 10.29	29	MAP 10.40	40	CAP 10 L29	29	MAP 10 L40	40
with lever/s, high construction	CAP 10.229	29 x 2	MAP 10.240	40 x 2	CAP 10 L229	29 x 2	MAP 10 L240	40 x 2
with pegs and aluminum cover ²⁾	CHP 10 CS	16	MHP 10 CS20	20				
with pegs and aluminum cover ²⁾	CHP 10 CS2	16 x 2	MHP 10 CS220	20 x 2				
with pegs and aluminum cover, high construction ²⁾	CAP 10 CS	21	MAP 10 CS32	32				
with pegs and aluminum cover, high construction ²⁾	CAP 10 CS2	21 x 2	MAP 10 CS232	32 x 2				
with pegs and aluminum cover, high construction ²⁾	CAP 10 CS29	29	MAP 10 CS40	40				
with pegs and aluminum cover, high construction ²⁾	CAP 10 CS229	29 x 2	MAP 10 CS240	40 x 2				
with pegs and plastic cover ²⁾	CHP 10 CP	16	MHP 10 CP20	20				
with pegs and plastic cover ²⁾	CHP 10 CP2	16 x 2	MHP 10 CP220	20 x 2				
with pegs and plastic cover, high construction ²⁾	CAP 10 CP	21	MAP 10 CP32	32				
with pegs and plastic cover, high construction ²⁾	CAP 10 CP2	21 x 2	MAP 10 CP232	32 x 2				
with pegs and plastic cover, high construction ²⁾	CAP 10 CP29	29	MAP 10 CP40	40				
with pegs and plastic cover, high construction ²⁾	CAP 10 CP229	29 x 2	MAP 10 CP240	40 x 2				
with lever and aluminium cover					CHP 10 LS	16	MHP 10 LS20	20
with lever and aluminium cover					CHP 10 LS2	16 x 2	MHP 10 LS220	20 x 2
with lever and aluminium cover, high construction					CAP 10 LS	21	MAP 10 LS32	32
with lever and aluminium cover, high construction					CAP 10 LS2	21 x 2	MAP 10 LS232	32 x 2
with lever and aluminium cover, high construction					CAP 10 LS29	29	MAP 10 LS40	40
with lever and aluminium cover, high construction					CAP 10 LS229	29 x 2	MAP 10 LS240	40 x 2

¹⁾ can only be used only with a complete cable gland (to be purchased separately)

²⁾ may be combined with enclosures:
- CHO/CAO 10 X and CHV/CAV 10 X
- MHO/MAO 10 X and MHV/MAV 10 X

IMPORTANT NOTE: The enclosures ensure IP66/IP69 degree of protection (or IP65 for hinged cover versions) when mated and locked with the closing levers. The cover (CS, CP) only ensures mechanical protection, but does not ensure IP65 degree of protection.

CR CLK
locking device for
CLASS locking levers
(page 666)



CAUS Type
4/4X/12
(except enclosures with plastic cover)



insulating cable gland or fittings without gasket



cable gland with O-Ring gasket

CHP - CAP and MHP - MAP ▲

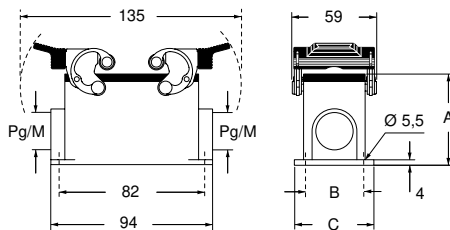
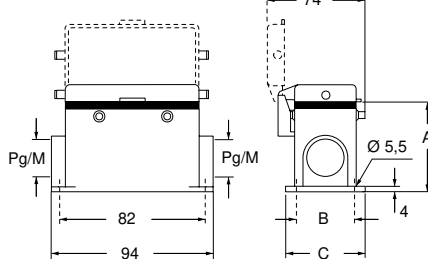
CHP CS/CP - CAP CS/CP and
MHP CS/CP - MAP CS/CP ●

type	A	B	C
CHP / MHP	57	40	52
CAP / MAP	74	45	57
CHP CS / MHP CS	57	40	52
CAP CS / MAP CS	74	45	57
CHP CP / MHP CP	57	40	52
CAP CP / MAP CP	74	45	57

CHP L - CAP L and MHP L - MAP L ▲

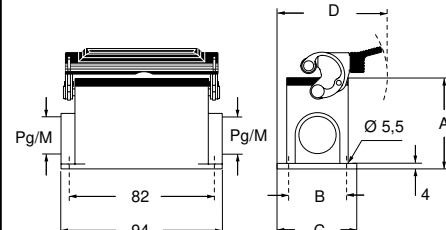

CHP LS - CAP LS and MHP LS - MAP LS ●

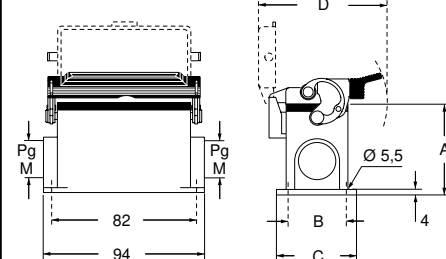

type	A	B	C	D
CHP L / MHP L	57	40	52	79.5
CAP L / MAP L	74	45	57	82
CHP LS / MHP LS	57	40	52	97
CAP LS / MAP LS	74	45	57	97



CH - CA - CF and MH - MA - MF C-TYPE standard version

inserts		page:
CDD	42 poles + ⊕	78
CDS	18 poles + ⊕	-
CDSH	18 poles + ⊕	87
CNE	10 poles + ⊕	111
CSE	10 poles + ⊕	-
CSH	10 poles + ⊕	111
CSH S	10 poles + ⊕	123
CCE	10 poles + ⊕	131
CMSH	3+2 (aux) poles + ⊕	136
CMCE	3+2 (aux) poles + ⊕	137
CSS	10 poles + ⊕	149
CQE	18 poles + ⊕	169
CX	8/24 poles + ⊕	194
MIXO	3 modules	262 - 317

hoods with 4 pegs



hoods with 4 pegs
M40 cable entry with 20 mm thread length



description	part No.	entry Pg	part No	entry M	part No.	entry Pg	part No.	entry M
with pegs, side entry	CHO 10	16	MHO 10.20	20				
with pegs, side entry			MHO 10.25	25				
with pegs, side entry, high construction	CAO 10.21	21	MAO 10.32	32				
with pegs, side entry, high construction	CAO 10.29	29	MAO 10.40	40				
with pegs, side entry, high construction, without adapter 1)					CFO 10.21	21	MFO 10.32	32
with pegs, side entry, high construction, without adapter 1)					CFO 10.29	29	MFO 10.40	40
with pegs, top entry	CHV 10	16						
with pegs, top entry 2)			MHV 10.20	20				
with pegs, top entry			MHV 10.25	25				
with pegs, top entry, high construction	CAV 10.21	21	MAV 10.32	32				
with pegs, top entry, high construction	CAV 10.29	29	MAV 10.40	40				
with pegs, top entry, high construction, without adapter 1)					CFV 10.21	21	MFV 10.32	32
with pegs, top entry, high construction, without adapter 1)					CFV 10.29	29	MFV 10.40	40
with pegs, frontal entry, high construction	CAF 10	16	MAF 10.20	20				
with pegs, frontal entry, high construction, without adapter 1)	CFF 10	16	MFF 10.20	20				

1) enclosure without adapter, threaded on the body, to be used only with a complete cable gland.

2) can only be used with a complete cable gland (to be purchased separately).

IP degrees are according to the type of lever of the counterpart enclosures.
Alternatively, hoods with pegs may be coupled with fixed enclosures:
- C-TYPE, IP65 or IP66/IP69 stainless steel lever, from page 393 to page 400
- C7, IP66/IP67/IP69 stainless steel lever, page 438
- CV, IP65 or IP66/IP69 stainless steel lever, page 448 and 449

cAUS® Type 4/4X/12



insulating cable gland or fittings without gasket



cable gland with O-Ring gasket
IP67 if hoods without adapters coupled with IP67 housings

CHO (CAO) and MHO (MAO)

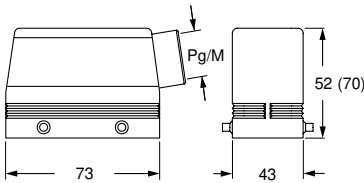

CHV (CAV) and MHV (MAV)

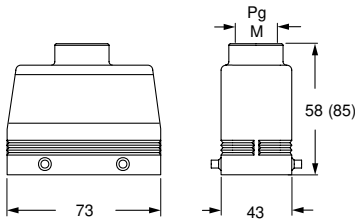

CAF/CFF and MAF/MFF

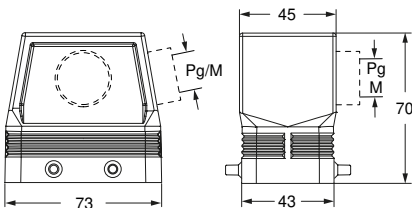

CFO and MFO

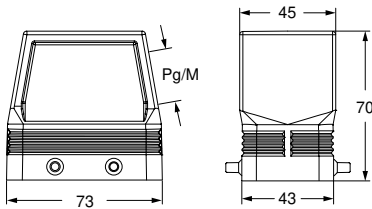

CFV and MFV

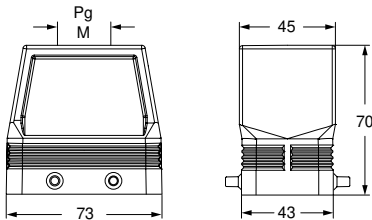

CH - CA - CF and MH - MA - MF C-TYPE standard version

inserts		page:
CDD	42 poles + ⊕	78
CDS	18 poles + ⊕	-
CDSH	18 poles + ⊕	87
CNE	10 poles + ⊕	111
CSE	10 poles + ⊕	-
CSH	10 poles + ⊕	111
CSH S	10 poles + ⊕	123
CCE	10 poles + ⊕	131
CMSH	3+2 (aux) poles + ⊕	136
CMCE	3+2 (aux) poles + ⊕	137
CSS	10 poles + ⊕	149
CQE	18 poles + ⊕	169
CX	8/24 poles + ⊕	194
MIXO	3 modules	262 - 317

hoods with 2 pegs**hoods with 2 pegs
M40 cable entry with 20 mm thread length**

description	part No.	entry Pg	part No	entry M	part No.	entry Pg	part No.	entry M
with pegs, side entry	CHO 10 L	16	MHO 10 L20	20				
with pegs, side entry			MHO 10 L25	25				
with pegs, side entry, high construction	CAO 10 L21	21	MAO 10 L32	32				
with pegs, side entry, high construction	CAO 10 L29	29	MAO 10 L40	40				
with pegs, side entry, high construction, without adapter ¹⁾					CFO 10 L21	21	MFO 10 L32	32
with pegs, side entry, high construction, without adapter ¹⁾					CFO 10 L29	29	MFO 10 L40	40
with pegs, top entry	CHV 10 L	16						
with pegs, top entry ²⁾			MHV 10 L20	20				
with pegs, top entry			MHV 10 L25	25				
with pegs, top entry, high construction	CAV 10 L21	21	MAV 10 L32	32				
with pegs, top entry, high construction	CAV 10 L29	29	MAV 10 L40	40				
with pegs, top entry, high construction, without adapter ¹⁾					CFV 10 L21	21	MFV 10 L32	32
with pegs, top entry, high construction, without adapter ¹⁾					CFV 10 L29	29	MFV 10 L40	40

¹⁾ enclosure without adapter, threaded on the body, to be used only with a complete cable gland.

²⁾ can only be used with a complete cable gland (to be purchased separately).

IP degrees are according to the type of lever of the counterpart enclosures.

Alternatively, hoods with pegs may be coupled with fixed enclosures:

- C-TYPE, IP65 or IP66/IP69 stainless steel lever, from page 393 to page 400
- C7, IP66/IP67/IP69 stainless steel lever, page 438
- CV, IP65 or IP66/IP69 stainless steel lever, page 448 and 449

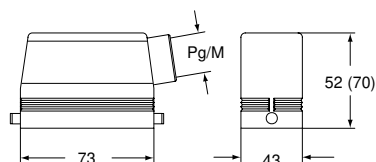
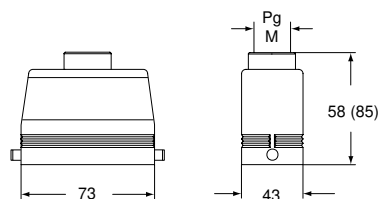
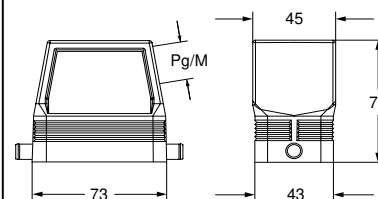
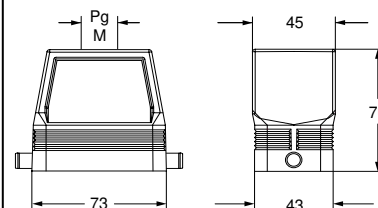
CHO L (CAO L) and MHO L (MAO L)**CHV L (CAV L) and MHV L (MAV L)****CFO L and MFO L****CFV L and MFV L**

CALUS® Type 4/4X/12



insulating cable gland or fittings without gasket



cable gland with O-Ring gasket



CH - CF and MA - MF C-TYPE standard version

inserts		page:
CDD	42 poles + ⊕	78
CDS	18 poles + ⊕	-
CDSH	18 poles + ⊕	87
CNE	10 poles + ⊕	111
CSE	10 poles + ⊕	-
CSH	10 poles + ⊕	111
CSH S	10 poles + ⊕	123
CCE	10 poles + ⊕	131
CMSH	3+2 (aux) poles + ⊕	136
CMCE	3+2 (aux) poles + ⊕	137
CSS	10 poles + ⊕	149
CQE	18 poles + ⊕	169
CX	8/24 poles + ⊕	194
MIXO	3 modules	262 - 317

hoods with double top entry



description	part No.	entry Pg	part No	entry M
with pegs for two levers				
used with enclosures size "57.27"	CAV 10.213	13,5 x 2	MAV 10.220	20 x 2
with pegs for two levers, without adapter ¹⁾				
used with enclosures size "57.27"	CFV 10.213	13,5 x 2	MFV 10.220	20 x 2

¹⁾ enclosure without adapter, threaded on the body, to be used only with a complete cable gland.

IP degrees are according to the type of lever of the counterpart enclosures.

Alternatively, hoods with pegs may be coupled with fixed enclosures:

- C-TYPE, IP65 or IP66/IP69 stainless steel lever, from page 393 to page 400
- C7, IP66/**IP67**/IP69 stainless steel lever, page 438
- CV, IP65 or IP66/IP69 stainless steel lever, page 448 and 449

CAV/CFV and MAV/MFV

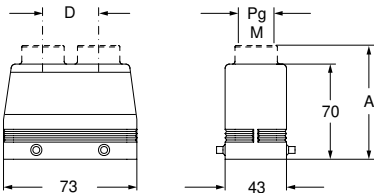

part No.	A	B
CAV 10.213 - MAV 10.220	82 (84,5)	26 (28,5)
CFV 10.213 - MFV 10.220	-	28,5 (26)

CAV[®]US Type 4/4X/12



insulating cable gland or fittings without gasket



cable gland with O-Ring gasket
IP67 if hoods without adapters coupled with IP67 housings

CH - CA - CF and MH - MA - MF C-TYPE standard version

inserts		page:
CDD	42 poles + ⊕	78
CDS	18 poles + ⊕	-
CDSH	18 poles + ⊕	87
CNE	10 poles + ⊕	111
CSE	10 poles + ⊕	-
CSH	10 poles + ⊕	111
CSH S	10 poles + ⊕	123
CCE	10 poles + ⊕	131
CMSH	3+2 (aux) poles + ⊕	136
CMCE	3+2 (aux) poles + ⊕	137
CSS	10 poles + ⊕	149
CQE	18 poles + ⊕	169
CX	8/24 poles + ⊕	194
MIXO	3 modules	262 - 317

hoods with 2 levers**hoods with 2 levers
M40 cable entry with 20 mm thread length**

description	part No.	entry Pg	part No.	entry M	part No.	entry M
with levers and gasket, side entry, high construction, without adapter ¹⁾					MFO 10 G40	40
with levers and gasket, top entry	CHV 10 G	16	MHV 10 G25	25		
with levers and gasket, top entry, high construction	CAV 10 G	21	MAV 10 G25	25		
with levers and gasket, top entry, high construction	CAV 10 G29	29	MAV 10 G32	32		
with levers and gasket, top entry, high construction, without adapter ¹⁾	CFV 10 G	21	MFV 10 G25	25		
with levers and gasket, top entry, high construction, without adapter ¹⁾	CFV 10 G29	29	MFV 10 G32	32		
with levers and gasket, top entry, high construction, without adapter ¹⁾					MFV 10 G40	40

¹⁾ enclosure without adapter, threaded on the body, to be used only with a complete cable gland.

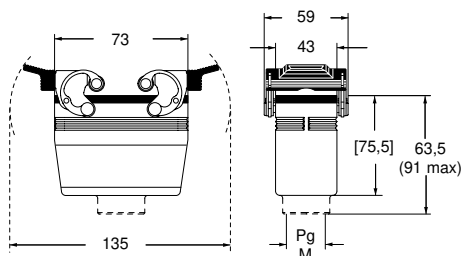
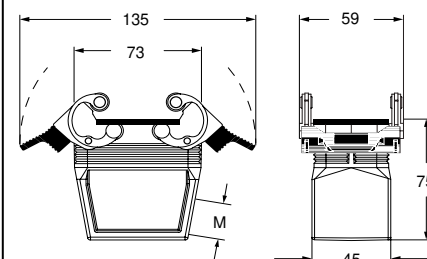
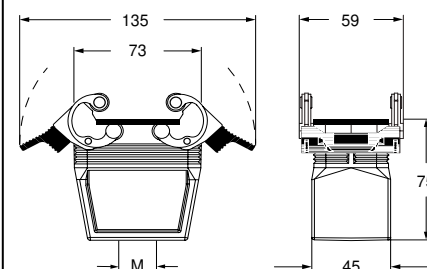
**CHV G (CAV G) and [CFV G],
MHV G (MAV G) and [MFV G]****MFO 10 G40****MFV 10 G40**

CAIUS® Type
4/4X/12



insulating cable gland or fittings
without gasket



cable gland
with O-Ring gasket



CH - CA - CF and MH - MA - MF C-TYPE standard version

inserts		page:
CDD	42 poles + ⊕	78
CDS	18 poles + ⊕	-
CDSH	18 poles + ⊕	87
CNE	10 poles + ⊕	111
CSE	10 poles + ⊕	-
CSH	10 poles + ⊕	111
CSH S	10 poles + ⊕	123
CCE	10 poles + ⊕	131
CMSH	3+2 (aux) poles + ⊕	136
CMCE	3+2 (aux) poles + ⊕	137
CSS	10 poles + ⊕	149
CQE	18 poles + ⊕	169
CX	8/24 poles + ⊕	194
MIXO	3 modules	262 - 317

hoods with 1 lever



hoods with 1 lever
M40 cable entry with 20 mm thread length



description	part No.	entry Pg	part No	entry M	part No.	entry M
with lever and gasket, side entry, high construction, without adapter ¹⁾					MFO 10 LG40	40
with lever and gasket, top entry	CHV 10 LG	16	MHV 10 LG25	25		
with lever and gasket, top entry, high construction	CAV 10 LG21	21	MAV 10 LG25	25		
with lever and gasket, top entry, high construction	CAV 10 LG29	29	MAV 10 LG32	32		
with lever and gasket, top entry, high construction, without adapter ¹⁾	CFV 10 LG21	21	MFV 10 LG25	25		
with lever and gasket, top entry, high construction, without adapter ¹⁾	CFV 10 LG29	29	MFV 10 LG32	32		
with lever and gasket, top entry, high construction, without adapter ¹⁾					MFV 10 LG40	40

¹⁾ enclosure without adapter, threaded on the body, to be used only with a complete cable gland.

CHV LG (CAV LG) and [CFV LG],
MHV LG (MAV LG) and [MFV LG]

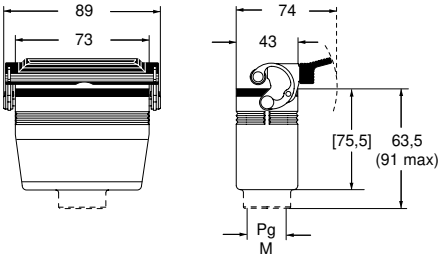

MFO 10 LG40

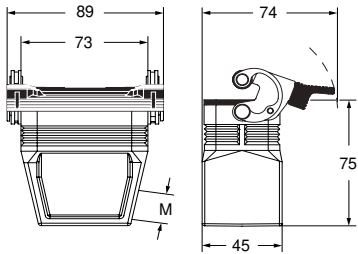

MFV 10 LG40

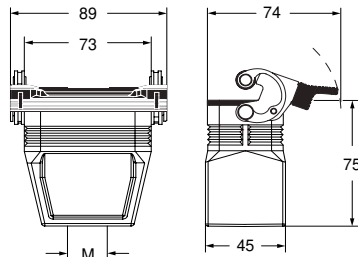

CALUS Type 4/4X/12



insulating cable gland or fittings
without gasket



cable gland
with O-Ring gasket

CH - CA and MH - MA C-TYPE standard version

inserts

CDD	42 poles + ⊕	78
CDS	18 poles + ⊕	-
CDSH	18 poles + ⊕	87
CNE	10 poles + ⊕	111
CSE	10 poles + ⊕	-
CSH	10 poles + ⊕	111
CSH S	10 poles + ⊕	123
CCE	10 poles + ⊕	131
CMSH	3+2 (aux) poles + ⊕	136
CMCE	3+2 (aux) poles + ⊕	137
CSS	10 poles + ⊕	149
CQE	18 poles + ⊕	169
CX	8/24 poles + ⊕	194
MIXO	3 modules	262 - 317

page:

hoods with 2 levers

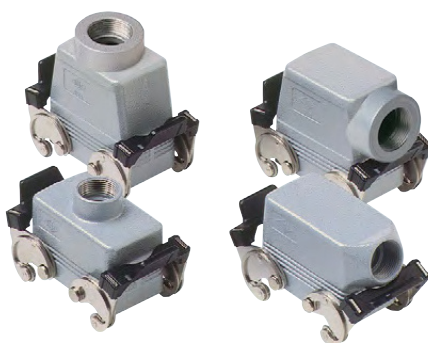

covers

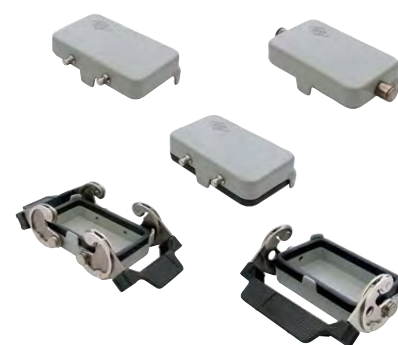

description	part No.	entry Pg	part No	entry M	part No. (with eyelet)	part No. (with loop)
with levers, side entry ¹⁾	CHO 10 X	16	MHO 10 X20	20		
with levers, side entry ¹⁾			MHO 10 X25	25		
with levers, side entry, high construction ¹⁾	CAO 10 X	21	MAO 10 X32	32		
with levers, side entry, high construction ¹⁾	CAO 10 X29	29	MAO 10 X40	40		
with levers, top entry ¹⁾	CHV 10 X	16				
with levers, top entry ³⁾			MHV 10 X20	20		
with levers, top entry ¹⁾			MHV 10 X25	25		
with levers, top entry, high construction ¹⁾	CAV 10 X	21	MAV 10 X32	32		
with levers, top entry, high construction ¹⁾	CAV 10 X29	29	MAV 10 X40	40		
with 4 pegs (for enclosures with 2 levers with gasket)					CHC 10	CHC 10 S
with 4 pegs and gasket (for enclosures with 2 levers) ²⁾						CHC 10 C
with 2 pegs (for enclosures with 1 lever with gasket)					CHC 10 L	CHC 10 SL
with 2 levers (for hoods with 4 pegs)						CHC 10 G
with 1 lever (for hoods with 2 pegs)						CHC 10 LG

¹⁾ may be combined with enclosures:

- CHI/CHP/CAP 10 CS/CP/C
- MHP/MAP 10 CS/CP

²⁾ may be combined with enclosures:

- CHO/CAO 10 X and CHV/CAV 10 X
- MHO/MAO 10 X and MHV/MAV 10 X

³⁾ can only be used with a complete cable gland (to be purchased separately).

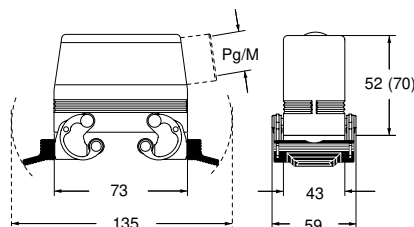
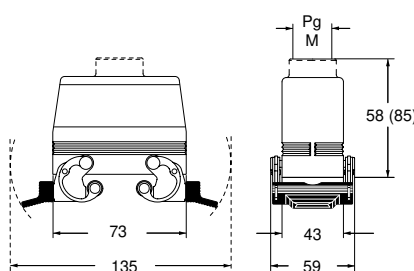
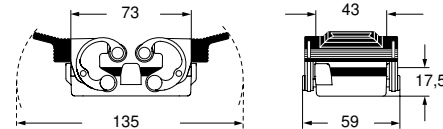
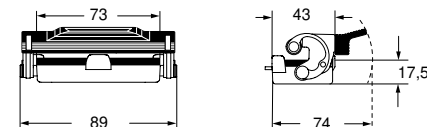
CHO X (CAO X) and MHO X (MAO X)**CHV X (CAV X) and MHV X (MAV X)****CHC (S)****CHC C****CHC L (SL)****CHC G****CHC LG**

For fixing
on housings

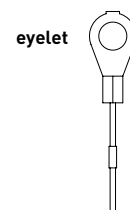

For fixing
on hoods

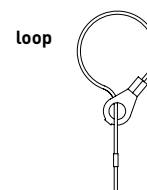

CAIUS Type
4/4X/12



insulating cable gland or fittings
without gasket



cable gland
with O-Ring gasket



CAC C-TYPE standard version

inserts		page:
CDD	42 poles + ⊕	78
CDS	18 poles + ⊕	-
CDSH	18 poles + ⊕	87
CNE	10 poles + ⊕	111
CSE	10 poles + ⊕	-
CSH	10 poles + ⊕	111
CSH S	10 poles + ⊕	123
CCE	10 poles + ⊕	131
CMSH	3+2 (aux) poles + ⊕	136
CMCE	3+2 (aux) poles + ⊕	137
CSS	10 poles + ⊕	149
CQE	18 poles + ⊕	169
CX	8/24 poles + ⊕	194
MIXO	3 modules	262 - 317

hoods without entry, to be drilled



hoods without entry, to be drilled



description	part No. (with 4 pegs)	part No. (with 2 pegs)
-------------	---------------------------	---------------------------

with pegs, high construction

CAC 10

CAC 10 L

Alternatively, hoods with pegs are coupled with fixed enclosures:

- C-TYPE, IP65 or IP66/IP69 stainless steel lever, from page 393 to page 400
- C7, IP66/IP67/IP69 stainless steel lever, page 438
- CV, IP65 or IP66/IP69 stainless steel lever, page 448 and 449

CAC 10 ●

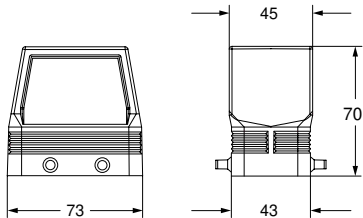

CAC 10 L ▲

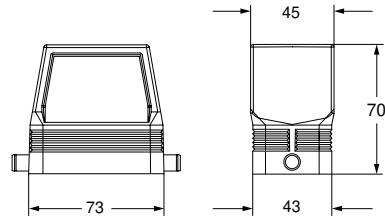

CALUS® Type 4/4X/12



● IP67 if coupled with IP67 housings

CH bulkhead connectors

inserts		page:
CD	40, 64 poles + ⊕	70, 72
CDD	24, 42, 72, 108 poles + ⊕	76 - 81
CDS	9, 18, 27, 42 poles + ⊕	-
CDSH	9, 18, 27, 42 poles + ⊕	86 - 89
CDSH NC	6 poles + ⊕	95
CNE	6, 10, 16, 24 poles + ⊕	110 - 113
CSE	6, 10, 16, 24 poles + ⊕	-
CSH	6, 10, 16, 24 poles + ⊕	110 - 113
CSH S	6, 10, 16, 24 poles + ⊕	122 - 125
CCE	6, 10, 16, 24 poles + ⊕	130 - 133
CMSH	3+2, 6+2, 10+2 (aux) poles + ⊕	136 - 140
CMCE	3+2, 6+2, 10+2 (aux) poles + ⊕	137 - 141
CSS	6, 10, 16, 24 poles + ⊕	148 - 151
CQE	10, 18, 32, 46 poles + ⊕	168 - 171
CQEE	40, 64 poles + ⊕	176 - 177
CP	6 poles + ⊕	178
CX	8/24, 6/36, 12/2 poles + ⊕	194 - 199
CX	4/0, 4/2, 4/8, 6/6 poles + ⊕	200 - 206
MIXO	2, 3, 4, 6 modules	262 - 317

bulkhead mounting housings with 2 or 4 pegs



bulkhead mounting housings



description	part No.	part No. C-TYPE	part No. C7
size "44.27"	CHI 06 LCH	CHI 06 L	C7I 06 L
size "57.27"	CHI 10 CH ¹⁾	CHI 10	C7I 10
size "77.27"	CHI 16 CH ¹⁾	CHI 16	C7I 16
size "104.27"	CHI 24 CH ¹⁾	CHI 24	C7I 24

¹⁾ may be combined also with enclosures:
- surface mounting housings (CHP / MHP...)
- hoods with lever and gasket (LG)

panel cut-out for bulkhead mounting housings

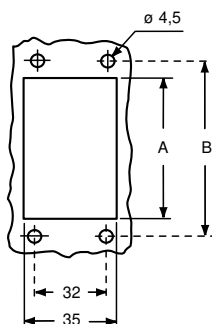

part No.	A	B
CHI 06 LCH - CHI 06 L - C7I 06 L	52	70
CHI 10 CH - CHI 10 - C7I 10	65	83
CHI 16 CH - CHI 16 - C7I 16	86	103
CHI 24 CH - CHI 24 - C7I 24	112	130

IMPORTANT NOTE: The enclosures ensure IP66 degree of protection when mated and locked with the closing levers.

CAUS Type 4/4X/12



CHI LCH

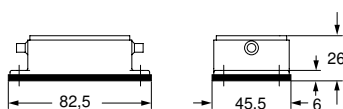

CHI 10 CH

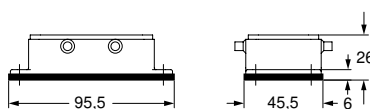

CHI 16 CH

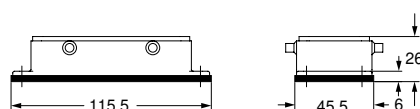

CHI 16 CH

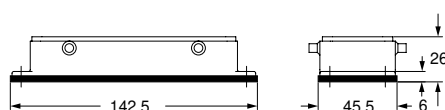

CHI L

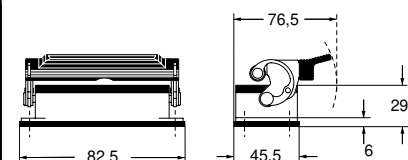

CHI

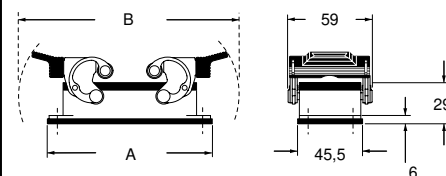

part No.	A	B
CHI 10	95,5	135
CHI 16	115,5	153
CHI 24	142,5	179,5

C7I L

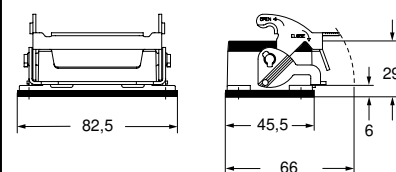

C7I

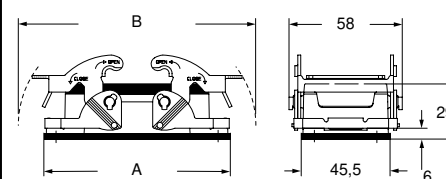

part No.	A	B
C7I 10	95,5	122
C7I 16	115,5	142,5
C7I 24	142,5	169

CL – ML Standard version with IL-BRID levers

inserts

CDD	42 poles + ⊕	78
CDS	18 poles + ⊕	-
CDSH	18 poles + ⊕	87
CNE	10 poles + ⊕	111
CSE	10 poles + ⊕	-
CSH	10 poles + ⊕	111
CSH S	10 poles + ⊕	123
CCE	10 poles + ⊕	131
CMSH	3+2 (aux) poles + ⊕	136
CMCE	3+2 (aux) poles + ⊕	137
CSS	10 poles + ⊕	149
CT, CTSE (16A)*	10 poles + ⊕	161
CQE	18 poles + ⊕	169
CX	8/24 poles + ⊕	194
MIXO	3 modules	262 - 317

* can be used only in bulkhead mounting housing

refer to CN.19 pages

page:

bulkhead mounting housings
with 2 levers

FROM SEPTEMBER 2022

surface mounting housings
with 2 levers

FROM SEPTEMBER 2022

description	part No.	entry M
with levers	CLI 10	
with levers	MLP 10.20	20
with levers	MLP 10.220	20 x 2
with levers, high construction	MLAP 10.25	25
with levers, high construction	MLAP 10.225	25 x 2
with levers, high construction	MLAP 10.32	32
with levers, high construction	MLAP 10.232	32 x 2
with levers, high construction	MLAP 10.40	40
with levers, high construction	MLAP 10.240	40 x 2

panel cut-out for bulkhead mounting housings

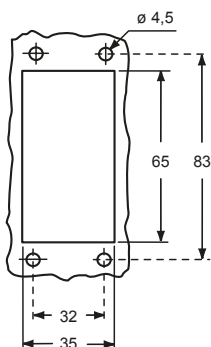

IMPORTANT NOTE: The enclosures ensure IP66/IP69 degree of protection (or IP65 for hinged cover versions) when mated and locked with the closing levers.

cURus
Type 4/4X/12 pending



insulating cable gland or fittings
without gasket



cable gland
with O-Ring gasket

CLI 10 ▲

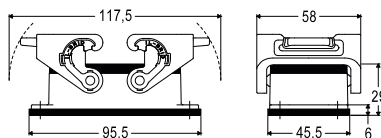

MLP 10.220

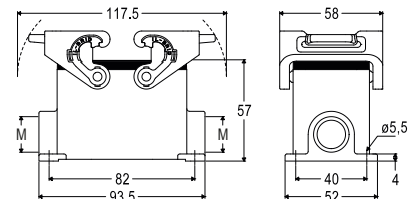

MLAP 10.225

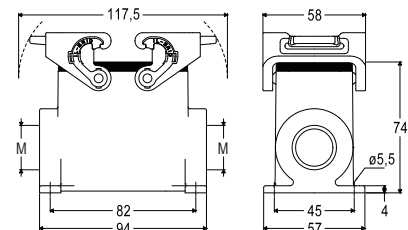

ML – MLA Standard version with IL-BRID levers

inserts

CDD	42 poles + ⊕	78
CDS	18 poles + ⊕	-
CDSH	18 poles + ⊕	87
CNE	10 poles + ⊕	111
CSE	10 poles + ⊕	-
CSH	10 poles + ⊕	111
CSH S	10 poles + ⊕	123
CCE	10 poles + ⊕	131
CMSH	3+2 (aux) poles + ⊕	136
CMCE	3+2 (aux) poles + ⊕	137
CSS	10 poles + ⊕	149
CQE	18 poles + ⊕	169
CX	8/24 poles + ⊕	194
MIXO	3 modules	262 - 317

page:

hoods with 2 levers



hoods with 2 lever

M40 cable entry with 20 mm thread length



refer to CN.19 pages

FROM SEPTEMBER 2022

FROM SEPTEMBER 2022

description	part No.	entry M	part No.	entry M
with levers, top entry	MLV 10 G25	25		
with levers, top entry, high construction	MLAV 10 G25	25		
with levers, top entry, high construction	MLAV 10 G32	32		
with levers, top entry, high construction	MLAV 10 G40	40		
with levers, side entry, high construction, without adapter ¹⁾			MLFO 10 G40	40
with levers, top entry, high construction, without adapter ¹⁾	MLFV 10 G25	25		
with levers, top entry, high construction, without adapter ¹⁾	MLFV 10 G32	32		
with levers, top entry, high construction, without adapter ¹⁾	MLFV 10 G40	40		

¹⁾ enclosure without adapter, threaded on the body,
to be used only with a complete cable gland.

MLV 10 G

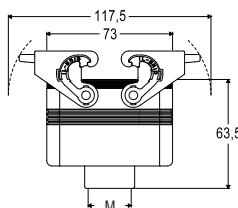

MLAV 10 G

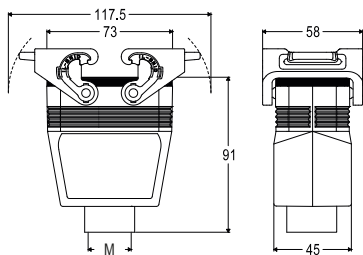

MLFV 10 G

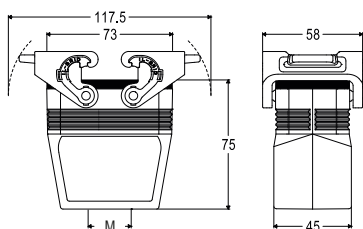

MLFO 10 G

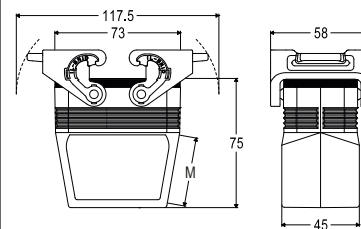

cURus
Type 4/4X/12 pending



insulating cable gland or fittings
without gasket



cable gland
with O-Ring gasket