

GOGAFLEX BRP Kupferschiene gelocht / prepunched copper bar

Gelochte Kupferschienen / prepunched copper bars

Kein Einsatz von Werkzeug für die Bohrung - Zeitersparnis bei der Verkabelung / no need for punching tools - wiring time savings

Material / material: Elektrolytkupfer Cu-ETP 99,90% / electrolyte copper

Zugfestigkeit / tensile strength: 250N/mm<sup>2</sup>

Elektrischer Widerstand / resistivity: 0,0172Ωmm<sup>2</sup>/m

Dichte / density: 8,9kg/dm<sup>3</sup>

| Typ     | Abmessungen<br>mm | L<br>mm | S<br>mm | P<br>mm | B<br>mm | Lochd. Ø<br>mm | Gewicht<br>kg | VPE<br>Stk. | ArtNr       | €<br>/pc. |
|---------|-------------------|---------|---------|---------|---------|----------------|---------------|-------------|-------------|-----------|
| type    | dimensions        |         |         |         |         | hole diameter  | weight        | PU          |             | /pc.      |
| BRP1000 | 25x5x1.750        | 25      | 5       |         |         |                | 1,39          |             | 1987005X25  | 40,99     |
| BRP1005 | 50x5x1.750        | 50      | 5       |         |         |                | 3,39          |             | 1987005X50  | 74,30     |
| BRP1010 | 63x5x1.750        | 63      | 5       |         |         |                | 4,39          |             | 1987005X63  | 90,50     |
| BRP1015 | 80x5x1.750        | 80      | 5       | 25      | 12,5    | 10,5           | 5,69          | 2           | 1987005X80  | 113,00    |
| BRP1020 | 100x5x1.750       | 100     | 5       |         |         |                | 7,24          |             | 1987005X100 | 139,80    |
| BRP1025 | 125x5x1.750       | 125     | 5       |         |         |                | 9,19          |             | 1987005X125 | 170,00    |
| BRP1030 | 50x10x1.750       | 50      | 10      |         |         |                | 6,70          |             | 1987010X50  | 120,90    |
| BRP1035 | 60x10x1.750       | 60      | 10      |         |         |                | 8,79          |             | 1987010X60  | 152,00    |
| BRP1040 | 80x10x1.750       | 80      | 10      | 25      | 12,5    | 10,5           | 11,30         | 2           | 1987010X80  | 176,00    |
| BRP1045 | 100x10x1.750      | 100     | 10      |         |         |                | 14,40         |             | 1987010X100 | 213,00    |
| BRP1050 | 120x10x1.750      | 120     | 10      |         |         |                | 18,30         |             | 1987010X120 | 269,00    |

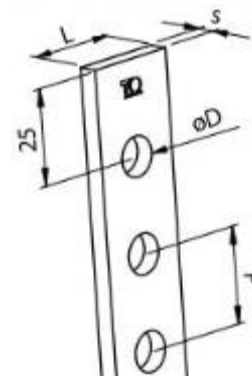
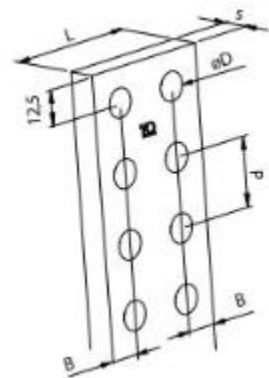

BRP1000

Strombelastbarkeit bei Temperaturänderung ΔT gem. DIN43671 /

Current loadability at temperature change ΔT acc. DIN 43671

| Abmessungen<br>mm | Querschnitt<br>mm <sup>2</sup> | ΔT 30°C |        |        |        | ΔT 50°C |        |        |        |
|-------------------|--------------------------------|---------|--------|--------|--------|---------|--------|--------|--------|
|                   |                                | 1-fach  | 2-fach | 3-fach | 4-fach | 1-fach  | 2-fach | 3-fach | 4-fach |
| dimensions        | cross-section                  | 1-fold  | 2-fold | 3-fold | 4-fold | 1-fold  | 2-fold | 3-fold | 4-fold |
| 25x5              | 125                            | 327     | 586    | 795    | 890    | 433     | 776    | 1053   | 1179   |
| 50x5              | 250                            | 583     | 994    | 1260   | 1411   | 772     | 1317   | 1669   | 1870   |
| 63x5              | 315                            | 718     | 1197   | 1494   | 1673   | 951     | 1586   | 1980   | 2217   |
| 80x5              | 400                            | 885     | 1450   | 1750   | 1960   | 1173    | 1921   | 2319   | 2597   |
| 100x5             | 500                            | 1080    | 1730   | 2050   | 2296   | 1431    | 2292   | 2716   | 3042   |
| 125x5             | 625                            | 1300    | 2022   | 2380   | 2666   | 1722    | 2679   | 3153   | 3532   |
| 20x10             | 500                            | 792     | 1404   | 1897   |        | 1050    | 1861   | 2514   |        |
| 60x10             | 600                            | 916     | 1600   | 2139   |        | 1214    | 2119   | 2834   |        |
| 80x10             | 800                            | 1153    | 1962   | 2595   |        | 1528    | 2600   | 3438   |        |
| 100x10            | 1.000                          | 1386    | 2306   | 3032   |        | 1836    | 3056   | 4017   |        |
| 120x10            | 1.200                          | 1618    | 2660   | 3478   |        | 2144    | 3524   | 4609   |        |

Preise gültig ab 01.01.2018 exkl. CU-Zuschlag und MwSt., freibleibend, Auftragsrabatt auf Anfrage / prices are valid from 01.01.2018 exkl. CU-surcharge and VAT, subject to change, discounts upon request

sonst. Konditionen siehe [www.gogatec.com/AGB.pdf](http://www.gogatec.com/AGB.pdf), techn. Änderungen vorbehalten / terms & conditions can be found on our website: [www.gogatec.com/AGB.pdf](http://www.gogatec.com/AGB.pdf); error, technical modifications and variations are reserved

**GOGAFLEX BRF Kupferschiene mit Gewinde / threaded copper bar**

**Kupferschienen mit Gewinde / threaded copper bars**

**Kein Einsatz von Werkzeug für die Bohrung - Zeitersparnis bei der Verkabelung / no need for punching tools - wiring time savings**

**Material / material:** Elektrolytkupfer Cu-ETP 99,90% / electrolyte copper

**Zugfestigkeit / tensile strength:** 250N/mm<sup>2</sup>

**Elektrischer Widerstand / resistivity:** 0,0172Ωmm<sup>2</sup>/m

**Dichte / density:** 8,9kg/dm<sup>3</sup>

| Typ<br>type | Abmessungen<br>mm<br>dimensions | L<br>mm | S<br>mm | P<br>mm | Gewinde<br>thread | Gewicht<br>kg<br>weight | VPE<br>Stk.<br>PU | ArtNr          | €<br>/pc.<br>/pc. |
|-------------|---------------------------------|---------|---------|---------|-------------------|-------------------------|-------------------|----------------|-------------------|
| BRF0990     | 12x2x1.000                      | 12      | 2       | 18      | M5                | 0,22                    | 10                | 1988002X12X1   | 8,02              |
| BRF0995     | 12x3x1.000                      | 12      | 3       | 18      | M5                | 0,32                    | 10                | 1988003X12X1   | 11,60             |
| BRF1000     | 12x4x1.000                      | 12      | 4       | 18      | M5                | 0,42                    | 10                | 1988004X12X1   | 12,67             |
| BRF1016     | 25x4x1.000                      | 25      | 4       | 25      | M6                | 0,80                    | 4                 | 1988004X25X1   | 23,53             |
| BRF1005     | 12x5x1.000                      | 12      | 5       | 18      | M5                | 0,49                    | 10                | 1988005X12X1   | 15,38             |
| BRF1010     | 15x5x1.000                      | 15      | 5       | 25      | M6                | 0,64                    | 4                 | 1988005X15X1   | 16,63             |
| BRF1015     | 20x5x1.000                      | 20      | 5       | 25      | M6                | 0,84                    | 4                 | 1988005X20X1   | 19,69             |
| BRF1017     | 25x5x1.000                      | 25      | 5       | 25      | M6                | 1,12                    | 4                 | 1988005X25X1   | 23,75             |
| BRF1020     | 32x5x1.000                      | 32      | 5       | 25      | M6                | 1,35                    | 4                 | 1988005X32X1   | 27,91             |
| BRF1025     | 12x4x2.000                      | 12      | 4       | 18      | M5                | 0,84                    | 10                | 1988004X12X2   | 25,78             |
| BRF1030     | 15x5x2.000                      | 15      | 5       | 25      | M6                | 1,18                    | 4                 | 1988005X15X2   | 33,33             |
| BRF1031     | 15x5x2.000PC                    | 15      | 5       | 18      | M6                | 1,16                    | 4                 | 1988005X15X2PC | 39,36             |
| BRF1035     | 20x5x2.000                      | 20      | 5       | 25      | M6                | 1,66                    | 4                 | 1988005X20X2   | 38,87             |
| BRF1040     | 30x5x2.000                      | 30      | 5       | 25      | M6                | 2,49                    | 4                 | 1988005X30X2   | 53,30             |
| BRF1042     | 32x5x2.000                      | 32      | 5       | 25      | M8                | 2,85                    | 4                 | 1988005X32X2   | 54,50             |
| BRF1041     | 32x5x2.000-W                    | 32      | 5       | 17,5    | M6                | 2,65                    | 4                 | 1988005X32X2W  | 54,50             |
| BRF1045     | 30x10x1.000                     | 30      | 10      | 25      | M8                | 2,49                    | 4                 | 1988010X30X1   | 57,10             |

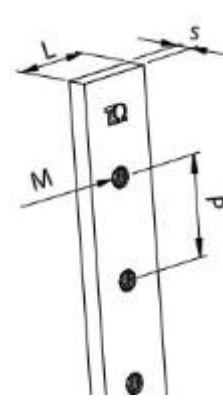

**Strombelastbarkeit bei Temperaturänderung ΔT gem. DIN43671 /**

**Current loadability at temperature change ΔT acc. DIN 43671**

| Abmessungen<br>mm<br>dimensions | Querschnitt<br>mm <sup>2</sup><br>cross-section | ΔT<br>30°C | ΔT<br>50°C |
|---------------------------------|-------------------------------------------------|------------|------------|
| 12x2                            | 24                                              | 108        | 143        |
| 12x3                            | 36                                              | 120        | 160        |
| 12x4                            | 48                                              | 160        | 212        |
| 25x4                            | 100                                             | 288        | 380        |
| 12x5                            | 60                                              | 183        | 241        |
| 15x5                            | 75                                              | 218        | 289        |
| 20x5                            | 100                                             | 274        | 363        |
| 25x5                            | 125                                             | 327        | 433        |
| 30x5                            | 150                                             | 379        | 502        |
| 32x5                            | 160                                             | 400        | 530        |
| 30x10                           | 300                                             | 573        | 756        |

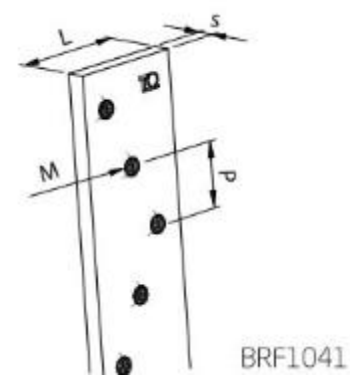

Preise gültig ab 01.01.2018 **exkl. CU-Zuschlag** und MwSt., freibleibend, Auftragsrabatt auf Anfrage / prices are valid from 01.01.2018 **excl. CU-surcharge** and VAT, subject to change, discounts upon request

sonst. Konditionen siehe [www.gogatec.com/AGB.pdf](http://www.gogatec.com/AGB.pdf), techn. Änderungen vorbehalten / terms & conditions can be found on our website: [www.gogatec.com/AGB.pdf](http://www.gogatec.com/AGB.pdf), error, technical modifications and variations are reserved

**GOGAFLEX PRP Kupferschiene ungelocht / copper bar unperforated**

**Material / material:** Elektrolytkupfer Cu-ETP 99,90% / electrolyte copper

**Zugfestigkeit / tensile strength:** 250N/mm<sup>2</sup>

**Elektrischer Widerstand / resistivity:** 0,0172Ωmm<sup>2</sup>/m

**Dichte / density:** 8,9kg/dm<sup>3</sup>



| Typ<br>type | Abmessungen<br>mm<br>dimensions | VPE<br>Stk.<br>PU | ArtNr       | €<br>/pc.<br>/pc. |
|-------------|---------------------------------|-------------------|-------------|-------------------|
| PRP2990     | 12x4x1.750                      | 2                 | 1981004X12  | 20,03             |
| PRP2000     | 20x5x1.750                      |                   | 1981005X20  | 41,76             |
| PRP2005     | 25x5x1.750                      |                   | 1981005X25  | 52,20             |
| PRP2010     | 30x5x1.750                      |                   | 1981005X30  | 62,70             |
| PRP2015     | 40x5x1.750                      |                   | 1981005X40  | 83,50             |
| PRP2020     | 50x5x1.750                      | 2                 | 1981005X50  | 104,40            |
| PRP2025     | 60x5x1.750                      |                   | 1981005X60  | 125,30            |
| PRP2030     | 80x5x1.750                      |                   | 1981005X80  | 167,00            |
| PRP2035     | 100x5x1.750                     |                   | 1981005X100 | 209,00            |
| PRP2040     | 125x5x1.750                     |                   | 1981005X125 | 261,00            |
| PRP2045     | 30x10x1.750                     |                   | 1981010X30  | 125,30            |
| PRP2050     | 40x10x1.750                     |                   | 1981010X40  | 167,00            |
| PRP2055     | 50x10x1.750                     |                   | 1981010X50  | 209,00            |
| PRP2060     | 60x10x1.750                     | 2                 | 1981010X60  | 251,00            |
| PRP2065     | 80x10x1.750                     |                   | 1981010X80  | 334,00            |
| PRP2070     | 100x10x1.750                    |                   | 1981010X100 | 418,00            |
| PRP2075     | 120x10x1.750                    |                   | 1981010X120 | 501,00            |

a.A. = auf Anfrage / upon request

**Strombelastbarkeit bei Temperaturänderung ΔT gem. DIN43671 /**

**Current loadability at temperature change ΔT acc. DIN 43671**

| Abmessungen<br>mm<br>dimensions | Querschnitt<br>mm <sup>2</sup><br>cross-section | ΔT 30°C          |                  |                  |                  | ΔT 50°C          |                  |                  |                  |
|---------------------------------|-------------------------------------------------|------------------|------------------|------------------|------------------|------------------|------------------|------------------|------------------|
|                                 |                                                 | 1-fach<br>1-fold | 2-fach<br>2-fold | 3-fach<br>3-fold | 4-fach<br>4-fold | 1-fach<br>1-fold | 2-fach<br>2-fold | 3-fach<br>3-fold | 4-fach<br>4-fold |
| 12x4                            | 48                                              | 160              |                  |                  |                  | 212              |                  |                  |                  |
| 20x5                            | 100                                             | 274              | 500              | 690              | 772              | 363              | 663              | 914              | 1023             |
| 25x5                            | 125                                             | 327              | 586              | 795              | 890              | 433              | 776              | 1053             | 1179             |
| 30x5                            | 150                                             | 379              | 672              | 896              | 1003             | 502              | 890              | 1187             | 1329             |
| 40x5                            | 200                                             | 482              | 836              | 1090             | 1220             | 639              | 1108             | 1444             | 1617             |
| 50x5                            | 250                                             | 583              | 994              | 1260             | 1411             | 772              | 1317             | 1670             | 1870             |
| 60x5                            | 300                                             | 688              | 1150             | 1440             | 1613             | 912              | 1524             | 1908             | 2137             |
| 80x5                            | 400                                             | 885              | 1450             | 1750             | 1960             | 1173             | 1921             | 2319             | 2597             |
| 100x5                           | 500                                             | 1080             | 1730             | 2050             | 2296             | 1431             | 2292             | 2716             | 3042             |
| 125x5                           | 625                                             | 1300             | 2022             | 2381             | 2666             | 1723             | 2679             | 3155             | 3532             |
| 30x10                           | 300                                             | 573              | 986              | 1289             |                  | 756              | 1300             | 1701             |                  |
| 40x10                           | 400                                             | 715              | 1230             | 1609             |                  | 944              | 1624             | 2124             |                  |
| 50x10                           | 500                                             | 852              | 1510             | 2040             |                  | 1129             | 2001             | 2703             |                  |
| 60x10                           | 600                                             | 985              | 1720             | 2300             |                  | 1305             | 2279             | 3048             |                  |
| 80x10                           | 800                                             | 1240             | 2110             | 2790             |                  | 1643             | 2796             | 3697             |                  |
| 100x10                          | 1000                                            | 1490             | 2480             | 3260             |                  | 1974             | 3286             | 4320             |                  |
| 120x10                          | 1200                                            | 1740             | 2860             | 3740             |                  | 2306             | 3790             | 4956             |                  |

Preise gültig ab 01.01.2018 exkl. CU-Zuschlag und MwSt., freibleibend, Auftragsrabatt auf Anfrage /

prices are valid from 01.01.2018 excl. CU-surcharge and VAT, subject to change, discounts upon request

sonst. Konditionen siehe [www.gogatec.com/AGB.pdf](http://www.gogatec.com/AGB.pdf), techn. Änderungen vorbehalten /

terms & conditions can be found on our website: [www.gogatec.com/AGB.pdf](http://www.gogatec.com/AGB.pdf), error, technical modifications and variations are reserved