



GOGAPIN KSDIN-RK Presskabelschuh unisoliert Teil 1 / *uninsulated compression cable lugs*

Material / *material*: E-CU gal Sn. Rohr nach DIN 40500 / *E-CU tube tin-plated acc. DIN 40500*

Zulassung / *approval*: UL listed

Normen / *standards*: DIN 46235

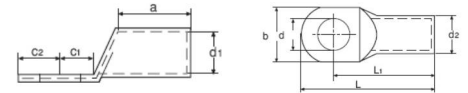

Passende Werkzeuge siehe GOGATOOL Katalog / *for appropriate tools please see GOGATOOL catalog*

mm ² <i>range</i>	Loch für <i>hole size</i>	Wk DIN	Abmessung mm <i>dimensions mm</i>								Gewicht/100Stk. <i>weight /100 pcs.</i>	VPE Stk. <i>PU</i>	Typ <i>type</i>	ArtNr	€/100 Stk. <i>/100 pcs.</i>
			d	d1	d2	l1	a	b	c1	c2	kg				
6	M5	5	5,5	3,8	5,5	24,0	10,0	8,5	6,5	7,5	0,35	100	KSDIN-RK-6-M5	126010006005	43,54
	M6		5,5	3,8	5,5	24,0	10,0	8,5	7,5	8,0	0,35	100	KSDIN-RK-6-M6	126010006006	39,19
	M8		5,5	3,8	5,5	24,0	10,0	13,0	10,0	10,0	0,35	100	*KSDIN-RK-6-M8	126010006008	48,04
10	M5	6	5,3	4,5	6,0	27,0	10,0	9,0	7,0	8,5	0,35	500	KSDIN-RK-10-M5	126010010005	24,70
	M6		6,4	4,5	6,0	27,0	10,0	9,0	7,5	8,5	0,35	500	KSDIN-RK-10-M6	126010010006	24,70
	M8		8,4	4,5	6,0	27,0	10,0	13,0	10,0	10,0	0,39	100	*KSDIN-RK-10-M8	126010010008	24,70
	M10		10,3	4,5	6,0	27,0	10,0	15,5	12,0	12,0	0,39	100	*KSDIN-RK-10-M10	126010010010	79,40
16	M6	8	6,4	5,5	8,5	36,0	20,0	13,0	7,5	8,0	1,16	250	KSDIN-RK-16-M6	126010016006	46,65
	M8		8,4	5,5	8,5	36,0	20,0	13,0	10,0	10,0	1,24	250	KSDIN-RK-16-M8	126010016008	48,02
	M10		10,5	5,5	8,5	36,0	20,0	17,0	12,0	12,0	1,32	250	KSDIN-RK-16-M10	126010016010	49,39
	M12		13,0	5,5	8,5	36,0	20,0	18,0	13,0	13,0	1,18	100	*KSDIN-RK-16-M12	126010016012	49,39
25	M6	10	6,4	7,0	10,0	38,0	20,0	14,0	7,5	8,0	1,45	200	KSDIN-RK-25-M6	126010025006	59,00
	M8		8,4	7,0	10,0	38,0	20,0	16,0	10,0	10,0	1,55	200	KSDIN-RK-25-M8	126010025008	60,40
	M10		10,5	7,0	10,0	38,0	20,0	17,0	12,0	12,0	1,60	200	KSDIN-RK-25-M10	126010025010	61,80
	M12		13,0	7,0	10,0	38,0	20,0	19,0	13,0	13,0	1,55	100	KSDIN-RK-25-M12	126010025012	63,20
35	M6	12	6,4	8,2	12,5	42,0	20,0	17,0	7,5	8,0	3,00	120	KSDIN-RK-35-M6	126010035006	104,30
	M8		8,4	8,2	12,5	42,0	20,0	17,0	10,0	10,0	3,00	120	*KSDIN-RK-35-M8	126010035008	107,00
	M10		10,5	8,2	12,5	42,0	20,0	19,0	12,0	12,0	2,90	120	KSDIN-RK-35-M10	126010035010	109,80
	M12		13,0	8,2	12,5	42,0	20,0	21,0	13,0	13,0	2,90	100	KSDIN-RK-35-M12	126010035012	109,80
	M14		15,0	8,2	12,5	42,0	20,0	21,0	14,5	14,5	3,40	120	*KSDIN-RK-35-M14	126010035014	a.A.
50	M8	14	8,4	10,0	14,5	52,0	28,0	20,0	10,0	10,0	4,50	65	KSDIN-RK-50-M8	126010050008	156,00
	M10		10,5	10,0	14,5	52,0	28,0	22,0	12,0	12,0	4,50	65	KSDIN-RK-50-M10	126010050010	158,00
	M12		13,0	10,0	14,5	52,0	28,0	24,0	13,0	13,0	4,50	65	KSDIN-RK-50-M12	126010050012	158,00
	M14		15,0	10,0	14,5	52,0	28,0	24,0	14,5	14,5	4,50	65	*KSDIN-RK-50-M14	126010050014	161,00
	M16		17,0	10,0	14,5	52,0	28,0	28,0	16,0	16,0	4,50	100	KSDIN-RK-50-M16	126010050016	168,00
70	M8	16	8,4	11,5	16,5	55,0	28,0	24,0	10,0	10,0	5,80	50	KSDIN-RK-70-M8	126010070008	212,00
	M10		10,5	11,5	16,5	55,0	28,0	24,0	12,0	12,0	6,00	50	KSDIN-RK-70-M10	126010070010	198,00
	M12		13,0	11,5	16,5	55,0	28,0	24,0	13,0	13,0	6,00	50	KSDIN-RK-70-M12	126010070012	198,00
	M14		15,0	11,5	16,5	55,0	28,0	24,0	14,5	14,5	6,20	50	*KSDIN-RK-70-M14	126010070014	198,00
	M16		17,0	11,5	16,5	55,0	28,0	30,0	16,0	16,0	5,90	50	KSDIN-RK-70-M16	126010070016	198,00
95	M8	18	8,4	13,5	19,0	65,0	35,0	28,0	12,0	12,0	9,70	30	*KSDIN-RK-95-M8	126010095008	269,00
	M10		10,5	13,5	19,0	65,0	35,0	28,0	12,0	12,0	10,00	30	KSDIN-RK-95-M10	126010095010	269,00
	M12		13,0	13,5	19,0	65,0	35,0	28,0	13,0	13,0	9,00	30	KSDIN-RK-95-M12	126010095012	269,00
	M14		15,0	13,5	19,0	65,0	35,0	28,0	14,5	14,5	9,50	30	*KSDIN-RK-95-M14	126010095014	279,00
	M16		17,0	13,5	19,0	65,0	35,0	32,0	16,0	16,0	9,70	50	KSDIN-RK-95-M16	126010095016	279,00
120	M10	20	10,5	15,5	21,0	70,0	35,0	32,0	15,0	16,0	11,40	30	KSDIN-RK-120-M10	126010120010	349,00
	M12		13,0	15,5	21,0	70,0	35,0	32,0	16,0	17,0	11,00	30	KSDIN-RK-120-M12	126010120012	349,00
	M14		15,0	15,5	21,0	70,0	35,0	32,0	18,0	19,0	11,40	30	*KSDIN-RK-120-M14	126010120014	349,00
	M16		17,0	15,5	21,0	70,0	35,0	32,0	19,0	20,0	11,30	50	KSDIN-RK-120-M16	126010120016	349,00
	M20		21,0	15,5	21,0	70,0	35,0	38,0	21,0	22,0	11,20	50	KSDIN-RK-120-M20	126010120020	349,00
150	M10	22	10,5	17,0	23,5	78,0	35,0	34,0	15,0	16,0	16,00	25	KSDIN-RK-150-M10	126010150010	516,00
	M12		13,0	17,0	23,5	78,0	35,0	34,0	16,0	17,0	16,00	25	KSDIN-RK-150-M12	126010150012	516,00
	M14		15,0	17,0	23,5	78,0	35,0	34,0	19,0	20,0	16,80	25	*KSDIN-RK-150-M14	126010150014	530,00
	M16		17,0	17,0	23,5	78,0	35,0	34,0	19,0	20,0	16,20	25	KSDIN-RK-150-M16	126010150016	530,00
	M20		21,0	17,0	23,5	78,0	35,0	40,0	21,0	22,0	16,00	25	KSDIN-RK-150-M20	126010150020	555,00
185	M10	25	10,5	19,0	25,5	82,0	40,0	37,0	15,0	16,0	18,90	18	KSDIN-RK-185-M10	126010185010	582,00
	M12		13,0	19,0	25,5	82,0	40,0	37,0	16,0	17,0	18,40	18	KSDIN-RK-185-M12	126010185012	582,00
	M14		15,0	19,0	25,5	82,0	40,0	37,0	19,0	20,0	19,40	18	*KSDIN-RK-185-M14	126010185014	599,00
	M16		17,0	19,0	25,5	82,0	40,0	37,0	19,0	20,0	19,30	18	KSDIN-RK-185-M16	126010185016	604,00
	M20		21,0	19,0	25,5	82,0	40,0	40,0	21,0	22,0	19,30	18	KSDIN-RK-185-M20	126010185020	621,00

a.A. = auf Anfrage / *upon request*

* nicht genormt / *not normed*

Preise gültig ab 01.01.2017 exkl. MwSt., freibleibend, Auftragsrabatt auf Anfrage /

prices are valid from 01.01.2017 excl. VAT, subject to change, discounts upon request

sonst. Konditionen siehe www.gogatec.com/AGB.pdf, techn. Änderungen vorbehalten /

terms & conditions can be found on our website: www.gogatec.com/AGB.pdf, error, technical modifications and variations are reserved



GOGAPIN KSDIN-RK Presskabelschuh unisoliert Teil 2 / uninsulated compression cable lugs

Material / material: E-CU gal Sn. Rohr nach DIN 40500 / E-CU tube tin-plated acc. DIN 40500

Zulassung / approval: UL listed

Normen / standards: DIN 46235

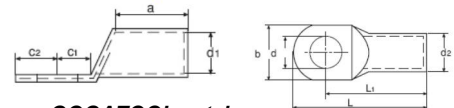

Passende Werkzeuge siehe GOGATOOL Katalog / for appropriate tools please see GOGATOOL catalog

mm ² range	Loch für hole	Wk DIN	Abmessung mm dimensions mm								Gewicht/100Stk. kg weight/100pcs.	VPE Stk. PU	Typ type	ArtNr	€/100 Stk. /100 pcs.
			d	d1	d2	l1	a	b	c1	c2					
240	M10	28	11,0	21,5	29,0	92,0	40,0	42,0	16,0	16,0	26,48	25	KSDIN-RK-240-M10	126010240010	918,00
	M12		13,0	21,5	29,0	92,0	40,0	42,0	16,0	17,0	27,50	12	KSDIN-RK-240-M12	126010240012	926,00
	M14		15,0	21,5	29,0	92,0	40,0	42,0	19,0	20,0	28,30	12	KSDIN-RK-240-M14	126010240014	936,00
	M16		17,0	21,5	29,0	92,0	40,0	42,0	16,0	20,0	27,50	12	KSDIN-RK-240-M16	126010240016	944,00
	M20		21,0	21,5	29,0	92,0	40,0	42,0	16,0	22,0	27,60	25	KSDIN-RK-240-M20	126010240020	947,00
300	M16	32	17,0	24,5	32,0	100,0	50,0	48,0	19,0	22,0	34,00	10	KSDIN-RK-300-M16	126010300016	1.183,00
	M20		21,0	24,5	32,0	100,0	50,0	48,0	22,0	22,0	33,80	20	KSDIN-RK-300-M20	126010300020	1.208,00
400	M12	38	13,0	27,5	8,5	115,0	70,0	55,0	25,0	25,0	69,50	10	KSDIN-RK-400-M12	126010400012	a.A.
	M14		15,0	27,5	38,5	115,0	70,0	55,0	25,0	25,0	69,40	10	KSDIN-RK-400-M14	126010400014	a.A.
	M16		17,0	27,5	38,5	115,0	70,0	55,0	25,0	25,0	67,50	10	KSDIN-RK-400-M16	126010400016	2.382,00
	M20		21,0	27,5	38,5	115,0	70,0	55,0	25,0	25,0	69,40	10	KSDIN-RK-400-M20	126010400020	a.A.
500	M16	42	17,0	31,0	42,0	125,0	70,0	60,0	25,0	25,0	83,00	10	KSDIN-RK-500-M16	126010500016	3.357,00
	M20		21,0	31,0	42,0	125,0	70,0	60,0	25,0	25,0	83,00	1	KSDIN-RK-500-M20	126010500020	2.796,00
625	M16	44	17,0	34,5	44,0	135,0	80,0	64,0	25,0	25,0	79,60	5	KSDIN-RK-625-M16	126010625016	a.A.
	M20		21,0	34,5	44,0	135,0	80,0	64,0	25,0	25,0	79,00	1	KSDIN-RK-625-M20	126010625020	2.868,00
800	M16	52	17,0	40,0	52,0	165,0	100,0	75,0	30,0	30,0	150,00	3	KSDIN-RK-800-M16	126010800016	a.A.
	M20		21,0	40,0	52,0	165,0	100,0	75,0	30,0	30,0	150,00	3	KSDIN-RK-800-M20	126010800020	a.A.
1000	M20	58	21,0	44,0	58,0	165,0	100,0	85,0	30,0	30,0	199,00	1	KSDIN-RK-1000-M20	126010999020	a.A.

a.A. = auf Anfrage / upon request

GOGAPIN KSE-SVDIN Pressverbinder unisoliert / uninsulated compression joints

Material / material: E-CU gal Sn. Rohr nach DIN 40500 / E-CU tube tin-plated acc. DIN 40500

Normen / standards: teilweise / partly DIN 46267

Passende Werkzeuge siehe GOGATOOL Katalog / for appropriate tools please see GOGATOOL catalog

mm ² range	Abmessung mm dimensions mm			Gewicht/100Stk. kg weight/100 pcs.	VPE Stk. PU	Typ type	ArtNr	€/100 Stk. /100 pcs.
	d1	d2	l					
6	3,8	5,5	28,5	0,310	100	KSDIN-SV-6	1260800060	45,96
10	4,5	6,0	30,0	0,350	100	KSDIN-SV-10	1260800100	21,95
16	5,5	8,5	50,0	1,450	100	KSDIN-SV-16	1260800160	48,02
25	7,0	10,0	50,0	1,770	100	KSDIN-SV-25	1260800250	60,40
35	8,2	12,5	50,0	2,900	100	KSDIN-SV-35	1260800350	107,00
50	10,0	14,5	56,0	4,260	50	KSDIN-SV-50	1260800500	158,00
70	11,5	16,5	56,0	5,410	50	KSDIN-SV-70	1260800700	212,00
95	13,5	19,0	70,0	8,700	50	KSDIN-SV-95	1260800950	302,00
120	15,5	21,0	70,0	9,700	50	KSDIN-SV-120	1260801200	396,00
150	17,0	23,5	80,0	14,500	50	KSDIN-SV-150	1260801500	563,00
185	19,0	25,5	85,0	17,000	25	KSDIN-SV-185	1260801850	659,00
240	21,5	29,0	90,0	23,500	25	KSDIN-SV-240	1260802400	988,00
300	24,5	32,0	100,0	29,230	25	KSDIN-SV-300	1260803000	a.A.
400	27,5	38,5	150,0	75,320	10	KSDIN-SV-400	1260804000	a.A.
500	31,0	42,0	160,0	79,100	5	KSDIN-SV-500	1260805000	a.A.
625	34,5	44,0	160,0	89,400	5	KSDIN-SV-625	1260806250	a.A.
800	40,0	52,0	200,0	151,200	3	KSDIN-SV-800	1260808000	a.A.
1000	44,0	58,0	200,0	198,500	3	KSDIN-SV-1000	1260809990	a.A.

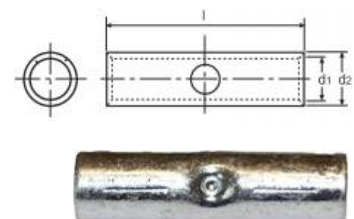

a.A. = auf Anfrage / upon request

Preise gültig ab 01.01.2017 exkl. MwSt., freibleibend, Auftragsrabatt auf Anfrage /

prices are valid from 01.01.2017 excl. VAT, subject to change, discounts upon request

sonst. Konditionen siehe www.gogatec.com/AGB.pdf, techn. Änderungen vorbehalten /

terms & conditions can be found on our website: www.gogatec.com/AGB.pdf, error, technical modifications and variations are reserved