

**GOGAPIN SS-RK Edelstahl Kabelschuhe für Rundleiter / stainless steel cable lugs for round conductor**

**Material / material:** Edelstahl AISI 304 oder AISI316 / stainless steel AISI304 or AISI316  
**Normen / standards:** Rohrabmessungen nach / tube dimensions acc. to DIN 46239

**Passende Werkzeuge siehe GOGATOOL Katalog / for appropriate tools please see GOGATOOL catalog**

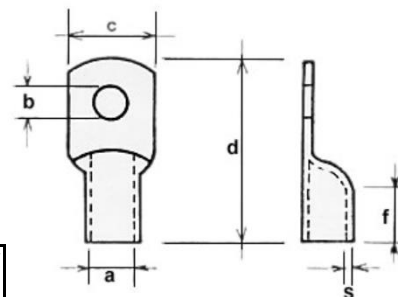

Leiter- $\phi$ mm <sup>2</sup> wire- $\phi$	Loch für hole size	Abmessungen mm dimensions mm						Typ type	ArtNr part no.	€/100 Stk. /100 pcs.
a	b	c	d	f	s					
<b>AISI 304 (DIN 1.4301)</b>										
2,5	M5	3,0	5,0	8,5	24,5	7,0	1,0	SS-RK-2,5-M5	127090050002-V2A	1 427,00
6	M6	3,5	6,5	11,5	37,0	10,0	1,0	SS-RK-6-M6	127090060006-V2A	1 637,00
	M8	3,5	8,5	11,5	37,0	10,0	1,0	SS-RK-6-M8	127090080006-V2A	1 637,00
10	M8	4,5	8,5	12,0	40,0	13,0	0,9	SS-RK-10-M8	127090080010-V2A	1 759,00
16	M8	5,5	8,5	11,8	48,5	21,0	1,25	SS-RK-16-M8	127090080016-V2A	1 923,00
	M10	5,5	10,5	15,0	48,5	21,0	1,25	SS-RK-16-M10	127090100016-V2A	1 923,00
25	M8	8,0	8,5	14,5	36,0	13,0	1,0	SS-RK-25-M8	127090080025-V2A	2 363,00
	M10	8,0	10,0	14,5	36,0	13,0	1,0	SS-RK-25-M10	127090100025-V2A	2 363,00
35	M6	9,0	7,0	15,5	44,0	17,0	1,0	SS-RK-35-M6	127090060035-V2A	2 496,00
	M10	9,0	10,5	16,0	44,0	17,0	1,0	SS-RK-35-M10	127090100035-V2A	2 496,00
50	M8	10,0	8,5	17,5	51,5	16,5	1,0	SS-RK-50-M8	127090080050-V2A	2 919,00
	M10	10,0	10,5	17,5	51,5	16,5	1,0	SS-RK-50-M10	127090100050-V2A	2 919,00
	M12	10,0	12,0	17,5	51,5	16,5	1,0	SS-RK-50-M12	127090120050-V2A	2 919,00
70	M8	12,0	9,0	22,0	54,0	13,0	1,5	SS-RK-70-M8	127090080070-V2A	3 381,00
	M12	12,0	12,0	22,0	54,0	13,0	1,5	SS-RK-70-M12	127090120070-V2A	3 381,00
95	M8	13,5	9,0	23,7	60,0	16,0	1,2	SS-RK-95-M8	127090080095-V2A	3 664,00
	M10	13,5	10,2	23,7	60,0	16,0	1,2	SS-RK-95-M10	127090100095-V2A	3 664,00
	M12	13,5	12,1	23,7	60,0	16,0	1,2	SS-RK-95-M12	127090120095-V2A	3 664,00
120	M8	15,0	8,5	26,5	61,5	18,0	1,5	SS-RK-120-M8	127090080120-V2A	3 986,00
	M10	15,0	10,5	26,5	61,5	18,0	1,5	SS-RK-120-M10	127090100120-V2A	3 986,00
	M12	15,0	12,0	26,5	61,5	18,0	1,5	SS-RK-120-M12	127090120120-V2A	3 986,00
<b>AISI 316 (DIN 1.4403)</b>										
2,5	M5	3,0	5,0	8,5	24,5	7,0	1,0	SS-RK-2,5-M5	127090050002-V4A	1 568,00
6	M6	3,5	6,5	11,5	37,0	10,0	1,0	SS-RK-6-M6	127090060006-V4A	1 789,00
	M8	3,5	8,5	11,5	37,0	10,0	1,0	SS-RK-6-M8	127090080006-V4A	1 789,00
10	M8	4,5	8,5	12,0	40,0	13,0	0,9	SS-RK-10-M8	127090080010-V4A	1 898,00
16	M8	5,5	8,5	11,8	48,5	21,0	1,25	SS-RK-16-M8	127090080016-V4A	2 079,00
	M10	5,5	10,5	15,0	48,5	21,0	1,25	SS-RK-16-M10	127090100016-V4A	2 079,00
25	M8	8,0	8,5	14,5	36,0	13,0	1,0	SS-RK-25-M8	127090080025-V4A	2 889,00
	M10	8,0	10,0	14,5	36,0	13,0	1,0	SS-RK-25-M10	127090100025-V4A	2 889,00
35	M6	9,0	7,0	15,5	44,0	17,0	1,0	SS-RK-35-M6	127090060035-V4A	3 018,00
	M10	9,0	10,5	16,0	44,0	17,0	1,0	SS-RK-35-M10	127090100035-V4A	3 018,00
50	M8	10,0	8,5	17,5	51,5	16,5	1,0	SS-RK-50-M8	127090080050-V4A	3 811,00
	M10	10,0	10,5	17,5	51,5	16,5	1,0	SS-RK-50-M10	127090100050-V4A	3 811,00
	M12	10,0	12,0	17,5	51,5	16,5	1,0	SS-RK-50-M12	127090120050-V4A	3 811,00
70	M8	12,0	9,0	22,0	54,0	13,0	1,5	SS-RK-70-M8	127090080070-V4A	4 498,00
	M12	12,0	12,0	22,0	54,0	13,0	1,5	SS-RK-70-M12	127090120070-V4A	4 498,00
95	M8	13,5	9,0	23,7	60,0	16,0	1,2	SS-RK-95-M8	127090080095-V4A	4 984,00
	M10	13,5	10,2	23,7	60,0	16,0	1,2	SS-RK-95-M10	127090100095-V4A	4 984,00
	M12	13,5	12,1	23,7	60,0	16,0	1,2	SS-RK-95-M12	127090120095-V4A	4 984,00
120	M8	15,0	8,5	26,5	61,5	18,0	1,5	SS-RK-120-M8	127090080120-V4A	5 899,00
	M10	15,0	10,5	26,5	61,5	18,0	1,5	SS-RK-120-M10	127090100120-V4A	5 899,00
	M12	15,0	12,0	26,5	61,5	18,0	1,5	SS-RK-120-M12	127090120120-V4A	5 899,00

Preise gültig ab 01.01.2019 exkl. MwSt., freibleibend, Auftragsrabatt auf Anfrage /  
 prices are valid from 01.01.2019 excl. VAT, subject to change, discounts upon request  
 sonst. Konditionen siehe [www.gogatec.com/AGB.pdf](http://www.gogatec.com/AGB.pdf), techn. Änderungen vorbehalten /  
 terms & conditions can be found on our website: [www.gogatec.com/AGB.pdf](http://www.gogatec.com/AGB.pdf); error, technical modifications and variations are reserved