

GOGAPIN Mehrbereichsklemme C-Form / multi purpose clamp C-form

Material / material: CU-ETP, zinnbeschichtet / coated tin

mm ²	Abmessung mm		Gewicht/100Stk.	VPE	Typ	ArtNr	€
range	b	l	kg	Stk.	type		/Stk.
	dimensions mm		weight /100 pcs.	PU			/pcs.
16-16	22	16,0	0,990	100	KSE-CK 16-16	123088C016016	2,24
25-25	28	23,0	1,750	50	KSE-CK 25-25	123088C025025	2,90
35-35	28	23,0	4,900	50	KSE-CK 35-35	123088C035035	4,15
50-50	28	23,0	4,900	50	KSE-CK 50-50	123088C050050	5,12
95-95	35	25,0	12,000	50	KSE-CK 95-95	123088C095095	16,78
240-240	-	-	-	10	KSE-CK 240-240	123088C240240	56,20

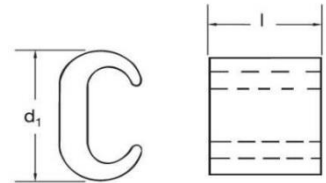

GOGAPIN Mehrbereichsklemme H-Form / multi purpose clamp H-form

Material / material: CU-ETP, zinnbeschichtet / coated tin

mm ²	Abmessung mm		Gewicht/100Stk.	VPE	Typ	ArtNr	€
range	b	l	kg	Stk.	type		/Stk.
	dimensions mm		weight /100 pcs.	PU			/pcs.
70-70	17	28,0	6,5	25	KSE-HK 70-70	123088H070070	12,75
95-95	22	30,0	10,0	25	KSE-HK 95-95	123088H095095	16,66
120-120	24	25,0	9,8	25	KSE-HK 120-120	123088H120120	24,56



Preise gültig ab 01.01.2018 exkl. MwSt., freibleibend, Auftragsrabatt auf Anfrage /
prices are valid from 01.01.2018 excl. VAT, subject to change, discounts upon request
sonst. Konditionen siehe www.gogatec.com/AGB.pdf, techn. Änderungen vorbehalten /
terms & conditions can be found on our website: www.gogatec.com/AGB.pdf; error, technical modifications and variations are reserved