

**GOGAPIN KSTR-RK mit Trichter f. feindrähtige Leiter / bell-mouth tubular cable lugs f. fine-stranded cables**

Material / material: EN 13600 Standardkupfer / standard copper  
Oberfläche / surface: verzinkt / tin plated  
Zulassungen / approvals: NFC 20-130

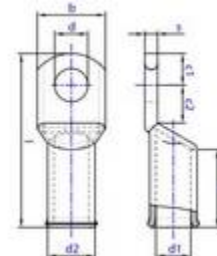

mm <sup>2</sup> range	Loch für hole size	d	d1	d2	Abmessung mm dimensions mm				VPE Stk. PU	Typ type	ArtNr	€/100 Stk. /100 Stk.	
10	M5	5,5			32,2		33,0	6,2	6,6	500	KSTR-RK-10-M5	125T10010005	23,00
	M6	6,5	4,3	6,8	32,2	13,7	11,0	6,2	6,6		KSTR-RK-10-M6	125T10010006	23,00
	M8	8,5			36,7		14,0	8,2	10,6		KSTR-RK-10-M8	125T10010008	27,00
16	M6	5,5			34,0		12,0	6,0	7,0	500	KSTR-RK-16-M6	125T10016006	36,00
	M8	6,5	5,3	8,0	39,0	14,7	16,0	8,0	11,0		KSTR-RK-16-M8	125T10016008	36,00
	M10	10,5			39,0		16,0	8,0	11,0		KSTR-RK-16-M10	125T10016010	42,00
25	M6	6,5			37,6		13,0	7,0	9,0	300	KSTR-RK-25-M6	125T10025006	54,00
	M8	10,5	6,6	9,5	41,6	14,6	16,0	9,0	1,0		KSTR-RK-25-M8	125T10025008	54,00
	M10	13,0			41,6		16,0	9,0	1,0		KSTR-RK-25-M10	125T10025010	58,00
35	M6	6,5			43,5		15,0	9,0		200	KSTR-RK-35-M6	125T10035006	78,00
	M8	8,5	7,9	11,0	43,5	16,5	17,0	9,0	10,0		KSTR-RK-35-M8	125T10035008	78,00
	M10	10,5			43,5		17,0	9,0			KSTR-RK-35-M10	125T10035010	a.A.
50	M6	6,5			43,5			7,0	9,0	120	KSTR-RK-50-M6	125T10050006	122,00
	M8	8,5	9,2	12,5	51,0	18,5	18,0	10,0	14,0		KSTR-RK-50-M8	125T10050008	122,00
	M10	10,5			51,0			10,0	14,0		KSTR-RK-50-M10	125T10050010	110,00
70	M8	8,5			55,5				10,0	100	KSTR-RK-70-M8	125T10070008	149,00
	M10	10,5	11,0	15,0	55,5	20,0	21,0	10,0	14,0		KSTR-RK-70-M10	125T10070010	149,00
	M12	13,0			55,5				10,0		KSTR-RK-70-M12	125T10070012	157,00
95	M8	8,5			67,5					80	KSTR-RK-95-M8	125T10095008	187,00
	M10	10,5			67,5						KSTR-RK-95-M10	125T10095010	187,00
	M12	13,0	13,1	17,0	67,5	27,5	24,0	13,5	15,5		KSTR-RK-95-M12	125T10095012	187,00
	M14	15,0			67,5						KSTR-RK-95-M14	125T10095014	198,00
	M16	17,0			67,5						KSTR-RK-95-M16	125T10095016	198,00
120	M10	10,5			75,5					50	KSTR-RK-120-M10	125T10120010	220,00
	M12	13,0	14,5	19,0	75,5	32,5	28,0	13,0	17,0		KSTR-RK-120-M12	125T10120012	220,00
	M14	15,0			75,5						KSTR-RK-120-M14	125T10120014	220,00
	M16	17,0			75,5						KSTR-RK-120-M16	125T10120016	220,00
150	M10	10,5			71,0	30,0	31,0	14,0	14,0	30	KSTR-RK-150-M10	125T10150010	275,00
	M12	13,0			74,8	31,5	30,0	15,0	15,0		KSTR-RK-150-M12	125T10150012	275,00
	M14	15,0	16,2	21,0	78,5	31,5	30,0	17,0	17,0		KSTR-RK-150-M14	125T10150014	275,00
	M16	17,0			78,5	31,5	30,0	17,0	17,0		KSTR-RK-150-M16	125T10150016	275,00
185	M10	10,5			79,0	34,0		15,0	15,0	30	KSTR-RK-185-M10	125T10185010	390,00
	M12	13,0	18,0	23,0	81,5	35,5	33,0	15,0	15,0		KSTR-RK-185-M12	125T10185012	390,00
	M14	15,0			85,5	35,5		17,0	17,0		KSTR-RK-185-M14	125T10185014	390,00
	M16	17,0			85,5	35,5		17,0	17,0		KSTR-RK-185-M16	125T10185016	379,00
240	M10	10,5			89,5	38,0	39,0	17,0	17,0	25	KSTR-RK-240-M10	125T10240010	549,00
	M12	13,0			89,5	39,5	37,0	17,0	17,0		KSTR-RK-240-M12	125T10240012	549,00
	M14	13,0	20,6	26,0	93,5	39,5	37,0	19,0	19,0		KSTR-RK-240-M14	125T10240014	549,00
	M16	15,0			93,5	39,5	37,0	19,0	19,0		KSTR-RK-240-M16	125T10240016	549,00
	M20	17,0			95,5	39,5	37,0	20,0	20,0		KSTR-RK-240-M20	125T10240020	549,00
300	M14	15,0			95,5			19,0	19,0	20	KSTR-RK-300-M14	125T10300014	741,00
	M16	17,0	23,0	28,0	95,5	41,0	41,0	19,0	19,0		KSTR-RK-300-M16	125T10300016	741,00
	M20	21,0			97,5			20,0	20,0		KSTR-RK-300-M20	125T10300020	741,00
400	M16	17,0	26,0	32,0	110,5	43,0	47,0	20,0	25,0	12	KSTR-RK-400-M16	125T10400016	1238,00
	M20	21,0			110,5						KSTR-RK-400-M20	125T10400020	1238,00

a.A. = auf Anfrage / upon request

Preise gültig ab 01.01.2017 exkl. MwSt., freibleibend, Auftragsrabatt auf Anfrage /

prices are valid from 01.01.2017 excl. VAT, subject to change, discounts upon request

sonst. Konditionen siehe [www.gogatec.com/AGB.pdf](http://www.gogatec.com/AGB.pdf), techn. Änderungen vorbehalten /

terms & conditions can be found on our website: [www.gogatec.com/AGB.pdf](http://www.gogatec.com/AGB.pdf), error, technical modifications and variations are reserved