



Anaconda adapter for Pepperl + Fuchs proximity switches.

These proximity switch adapters are specially developed for the new generation type of adapters (extra connection at the switch). The adapter is made from poly-carbonate so the light diodes are visible, while the switch is functioning. The construction is impact- and scratch-resistant. Due to the universal construction they are easy to connect in combination with almost all Anamet conduits. Also connection with the direct cable-switch connectors (old type proximity switches) is possible.

Material & Construction:

Construction: Nickel plated brass fitting, consisting of 5 parts (counter nut, clamping ring, ferrule, body and holder).

Material: Counter nut, body and ferrule are nickel plated brass with exception of size 3/8" till 1" where the ferrule is from galvanised steel. Clamping ring is made from PA6. The holder is made from poly-carbonate and impact and scratch resistant.

Temperature: -45 °C till +105 °C continuous.

Protection class: Depending on the protection class of the conduit. Connection between the adapter and the power connector is IP 65.

Colour: Metal, with transparent holder.

ANACONDA SPECIAL FITTINGS

PROXIMITY SWITCH ADAPTER

Proximity switch adapter for *Anaconda Sealtite*, IP 65 (for conduit details see chapters 3 and 4).



Thread	Sealtite Size	Makers Range	Min. Internal Bore (mm)	Dimensions in mm			Standard Package	Article Number	Weight (Kg/100)
				A	B	C			
M8 x 1	1/4"	-	5,2	-	-	-	10	883.308.0	3,0
M8 x 1	5/16"	-	8,3	-	-	-	10	883.310.0	3,4
M12 x 1	1/4"	-	5,2	-	-	-	10	883.312.0	3,0
M12 x 1	5/16"	-	8,3	-	-	-	10	883.316.0	3,4
M18 x 1	1/4"	-	5,2	-	-	-	10	883.314.0	3,0
M18 x 1	5/16"	-	8,3	-	-	-	10	883.318.0	3,4

Proximity switch adapter for *Multiflex type SL/SLI*, IP 40 (for conduit details see chapter 1).



Thread	SL/SLI Size	Makers Range	Min. Internal Bore (mm)	Dimensions in mm			Standard Package	Article Number	Weight (Kg/100)
				A	B	C			
M8 x 1	1/4"	-	5,2	-	-	-	10	883.308.6	3,4
M8 x 1	5/16"	-	8,3	-	-	-	10	883.310.6	4,0
M12 x 1	1/4"	-	5,2	-	-	-	10	883.312.6	3,4
M12 x 1	5/16"	-	8,3	-	-	-	10	883.316.6	4,0
M18 x 1	1/4"	-	5,2	-	-	-	10	883.314.6	3,4
M18 x 1	5/16"	-	8,3	-	-	-	10	883.318.6	4,0

Proximity switch adapter for *Multiflex type UI-CAP*, IP 40
(for conduit details see chapter 1).



Thread Inside	UI-CAP Size	Makers Range	Min. Internal Bore (mm)	Dimensions in mm			Standard Package	Article Number	Weight (Kg/100)
				A	B	C			
M8 x 1	6,0	-	5,2	-	-	-	10	883.308.7	3,4
M8 x 1	9,5	-	8,0	-	-	-	10	883.310.7	4,0
M12 x 1	6,0	-	5,2	-	-	-	10	883.312.7	3,4
M12 x 1	9,5	-	8,0	-	-	-	10	883.316.7	4,0
M18 x 1	6,0	-	5,2	-	-	-	10	883.314.7	3,4
M18 x 1	9,5	-	8,0	-	-	-	10	883.318.7	4,0

Proximity switch adapter for *Multitite type FCD/FCE*,
IP 65 (for conduit details see chapter 2).



Thread Inside	FCD/FCE Size	Makers Range	Min. Internal Bore (mm)	Dimensions in mm			Standard Package	Article Number	Weight (Kg/100)
				A	B	C			
M8 x 1	12	-	8,3	-	-	-	10	883.310.0	3,0
M12 x 1	12	-	8,3	-	-	-	10	883.316.0	3,0
M18 x 1	12	-	8,3	-	-	-	10	883.318.0	3,0

ANACONDA
SPECIAL
FITTINGS

PROXIMITY
SWITCH
ADAPTER

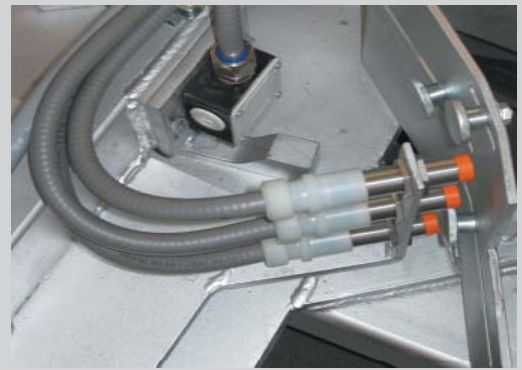

Adapter for various makes old version proximity switches.

These proximity switch adapters are used in combination with the old type of adapters (fixed wiring connection). Due to the construction they are easy to connect in combination with Sealtite conduit. Other combinations are not possible.

Material & Construction:

Construction: Polyamide fitting, consisting of 4 parts (counter nut, clamping ring, ferrule, and body).

Material: Counter nut, body and clamping ring are PA6. Ferrule is made of brass.

Temperature: -45 °C till +105 °C continuous.

Protection class: IP 65 (dust-proof, water-protected).

Colour: White.

**ANACONDA
SPECIAL
FITTINGS**

Proximity switch adapter for *Anaconda Sealtite*, IP 65 (for conduit details see chapters 3 and 4).



Thread	Sealtite Size	Makers Range	Min. Internal Bore (mm)	Dimensions in mm			Standard Package	Article Number	Weight (Kg/100)
				A	B	C			
M8 x 1	1/4"	-	5,2	-	-	-	25	883.208.0	0,8
M12 x 1	5/16"	-	8,3	-	-	-	25	883.212.0	1,2
M18 x 1	5/16"	-	8,3	-	-	-	25	883.218.0	1,4
M30 x 1,5	5/16"	-	8,3	-	-	-	25	883.230.0	2,8
ID 20 mm	5/16"	-	8,3	-	-	-	25	883.320.0	2,0
ID 34 mm	5/16"	-	8,3	-	-	-	25	883.334.0	3,0

**PROXIMITY
SWITCH
ADAPTER**



**ANACONDA
SPECIAL
FITTINGS**

**PROXIMITY
SWITCH
ADAPTER**



Anconda Adapter in full metal for various makes proximity switches.

These Anconda proximity switch adapters are used in combination with the various of adapters (fixed wiring connection) in hazardous environments. By using an inner thread for the proximity switch and an outer thread with locknut, this adapter is easy to mount and gives a perfect protection. Due to the construction they are easy to connect in combination with Sealtite conduit. Other combinations are also possible.



Material & Construction:

Construction: Nickel plated brass, consisting of 5 parts (counter nut, clamping ring, ferrule, body and locknut).

Material: Counter nut, ferrule, body and locknut are nickel plated brass. Clamping ring is made of Polyamide PA6.

Temperature: -45 °C till +105 °C continuous.

Protection class: IP 65.

Colour: Metal.

Proximity switch adapter for *Anconda Sealtite*, IP 65 (for conduit details see chapters 3 and 4).

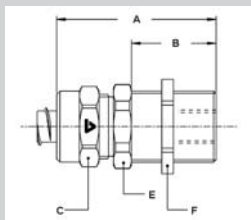

Female Thread size	Sealtite Size	Male Thread	Min. Internal Bore (mm)	Dimensions in mm					Standard Package	Article Number	Weight (Kg/100)
				A	B	C	E	F			
M8 x 1	1/4"	M12 x 1,5	5,2	34	12	19	17	15	10	884.008.0	3,0
M12 x 1	1/4"	M16 x 1,5	5,2	38	16	19	17	20	10	884.012.0	3,5
M14 x 1	1/4"	M18 x 1,5	5,2	42	20	19	20	22	10	884.014.0	4,0
M18 x 1	5/16"	M22 x 1,5	8,3	49	26	22	24	26	10	884.018.0	6,0
M30 x 1,5	5/16"	M35 x 1,5	8,3	53	30	22	36	46	5	884.030.0	13,0