



Anaconda compact fittings, UL & CSA, stainless steel AISI-316, for Anaconda Sealrite.

The compact version stainless steel Anaconda fittings can be used with all types of Anaconda Sealrite (except CNP). This Anaconda fitting is a universal fitting with shorter design and lower weight. Because the fitting and ferrule are made from Stainless steel AISI-316 they offer an excellent corrosion protection in combination with a nice appearance. The compact fittings have UL & CSA approval.

Construction: Stainless steel AISI-316, consisting of 4 parts (counter nut, clamping ring, ferrule and body).

Material: Counter nut, body are stainless steel AISI-316



and ferrule are stainless steel AISI-304. Clamping ring is made from PA6. The O-rings are from NBR rubber.

Special approvals: UL-514B and CSA C 22.2 (combined UL/CSA file # E 234207).

Suitable for use in hazardous environments according NEC:

- Article 501.10 (B) (2) Class I, Division 2
- Article 502.10 (A) (2) and (B) (2) Class II, Division 1 and 2
- Article 503.10 (A) (3) and (B) Class III, Division 1 and 2

Temperature: -45 °C till +105 °C continuous

Protection class: IP 67 (dust-proof, water-tight)

Colour: Metal

ISO straight fitting, compact, stainless steel AISI-316

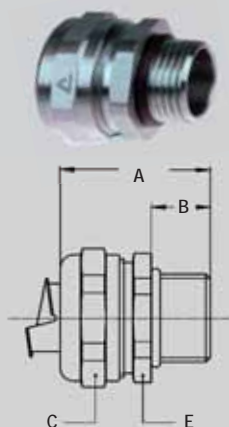

Thread	Sealrite Size (inch)	Min. Internal Bore (mm)	Dimensions in mm					Standard Package	Article Number	Weight (Kg/100)
			A	B	C	D	E			
M16 x 1,5	3/8"	11,0	31	10	26	-	24	10	712.116.9	3,9
M20 x 1,5	3/8"	11,0	31	10	26	-	24	10	712.117.9	4,0
M20 x 1,5	1/2"	14,5	32	10	29	-	27	10	712.120.9	4,4
M25 x 1,5	3/4"	19,4	33	10	35	-	33	5	712.125.9	6,6
M32 x 1,5	1"	24,7	36	12	45	-	42	5	712.132.9	11,7
M40 x 1,5	1.1/4"	33,3	40	13	53	-	50	2	712.140.9	16,0
M50 x 1,5	1.1/2"	38,0	46	14	62	-	58	2	712.150.9	25,3
M63 x 1,5	2"	49,0	52	16	76	-	72	2	712.163.9	38,6

ISO 90° fitting, compact, male, stainless steel AISI-316

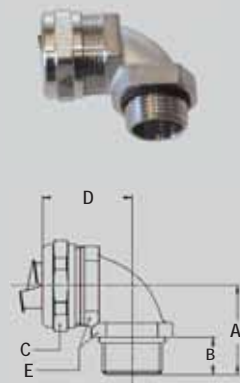

Thread	Sealrite Size (inch)	Min. Internal Bore (mm)	Dimensions in mm					Standard Package	Article Number	Weight (Kg/100)
			A	B	C	D	E			
M16 x 1,5	3/8"	11,0	26	10	26	31	22	10	712.516.9	6,6
M20 x 1,5	3/8"	11,0	26	10	26	32	24	10	712.517.9	7,9
M20 x 1,5	1/2"	14,5	28	10	29	34	27	10	712.520.9	9,2
M25 x 1,5	3/4"	19,4	32	10	35	40	33	5	712.525.9	16,2
M32 x 1,5	1"	24,7	40	12	45	49	42	5	712.532.9	27,8
M40 x 1,5	1.1/4"	33,3	46	13	53	53	52	2	712.540.9	40,1
M50 x 1,5	1.1/2"	38,0	52	14	62	57	60	2	712.550.9	57,5
M63 x 1,5	2"	49,0	62	16	76	68	72	2	712.563.9	90,6

NPT straight fitting, compact, male,
stainless steel AISI-316

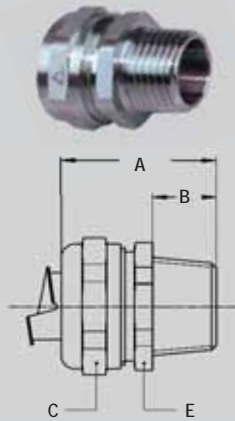

Thread NPT	Sealtite Size (inch)	Min. Internal Bore (mm)	Dimensions in mm					Standard Package	Article Number	Weight (Kg/100)
			A	B	C	D	E			
NPT 1/2"	3/8"	11,0	35	14	26	-	24	10	714.112.9	4,4
NPT 1/2"	1/2"	14,5	36	14	29	-	27	10	714.116.9	5,0
NPT 3/4"	3/4"	19,4	37	14	35	-	33	5	714.120.9	7,0
NPT 1"	1"	24,7	40	16	45	-	42	5	714.126.9	12,6
NPT 1.1/4"	1.1/4"	33,3	43	16	53	-	50	2	714.135.9	16,8
NPT 1.1/2"	1.1/2"	38,0	50	18	62	-	58	2	714.140.9	25,8
NPT 2"	2"	49,0	56	20	76	-	72	2	714.150.9	41,2

NPT 90° fitting, compact, male, stainless
steel AISI-316

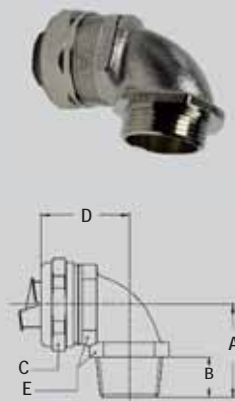

Thread NPT	Sealtite Size (inch)	Min. Internal Bore (mm)	Dimensions in mm					Standard Package	Article Number	Weight (Kg/100)
			A	B	C	D	E			
NPT 1/2"	3/8"	11,0	30	14	26	32	24	10	714.512.9	8,2
NPT 1/2"	1/2"	14,5	32	14	29	34	27	10	714.516.9	9,6
NPT 3/4"	3/4"	19,4	36	14	35	40	33	5	714.520.9	16,7
NPT 1"	1"	24,7	44	16	45	49	42	5	714.526.9	28,3
NPT 1.9/4"	1.1/4"	33,3	49	16	53	53	52	2	714.535.9	41,4
NPT 1.9/2"	1.1/2"	38,0	56	18	62	57	60	2	714.540.9	57,3
NPT 2"	2"	49,0	66	20	76	68	72	2	714.550.9	90,8

NPT straight fitting, compact, male,
stainless steel AISI-316 (incl. locknut)

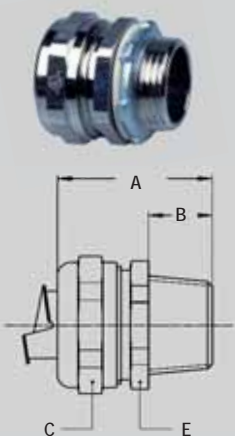

Thread NPT	Sealtite Size (inch)	Min. Internal Bore (mm)	Dimensions in mm					Standard Package	Article Number	Weight (Kg/100)
			A	B	C	D	E			
NPT 1/2"	3/8"	11,0	35	14	26	-	24	10	714.112.92	4,9
NPT 1/2"	1/2"	14,5	36	14	29	-	27	10	714.116.92	5,5
NPT 3/4"	3/4"	19,4	37	14	35	-	33	5	714.120.92	7,8
NPT 1"	1"	24,7	40	16	45	-	42	5	714.126.92	13,9
NPT 1.1/4"	1.1/4"	33,3	43	16	53	-	50	2	714.135.92	18,6
NPT 1.1/2"	1.1/2"	38,0	50	18	62	-	58	2	714.140.92	28,0
NPT 2"	2"	49,0	56	20	76	-	72	2	714.150.92	44,0

ANACONDA
SEALTITE®
SPECIAL

LIQUID-TIGHT
FITTINGS FOR
SEALTITE
IP 67



Anaconda stainless steel fittings for Anaconda Sealtite.

The stainless steel Anaconda fittings can be used with all types of Anaconda Sealtite (except CNP). These fittings are available in AISI-304 and AISI-316 and offer superior corrosion resistance. These stainless steel Anaconda fittings are mostly used in the off-shore, chemical and food industry. Because of the UL & CSA approvals the fittings are also suitable for export projects outside Europe.

Material & Construction:

Construction: Stainless steel (AISI-304) fitting, consisting of 4 parts (counter nut, clamping ring, ferrule and body).

Material: Counter nut and body are stainless steel (AISI-304) and the ferrule is from nickel plated brass. Clamping

ring and insert are from PA6 (red for ISO metric, blue for Pg and white for NPT).

Special approvals: UL-514B and CSA C 22.2 (combined UL/CSA file # E 234207).

Suitable for use in hazardous environments according NEC:

- Article 501.10 (B) (2) Class I, Division 2

- Article 502.10 (A) (2) and (B) (2) Class II, Division 1 and 2

- Article 503.10 (A) (3) and (B) Class III, Division 1 and 2

Temperature: -45 °C till +105 °C continuous (cable-hose-fittings are -40 °C till +100 °C).

Protection class: IP 67 (dust-proof, water-tight), with cable-hose fittings an IP 68 rate on the switchbox can be obtained.

Colour: Metal.

ANACONDA COMPACT FITTINGS

LIQUID-TIGHT FITTINGS FOR SEALTITE IP 67

ISO straight fitting, male, stainless steel (AISI-304).

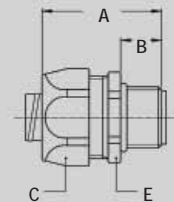

Thread ISO	Sealtite Size (inch)	Min. Internal Bore (mm)	Dimensions in mm					Standard Package	Article Number	Weight (Kg/100)
			A	B	C	D	E			
M16 x 1,5	5/16"	8,3	35	12	27	-	24	10	812.015.9*	4,8
M20 x 1,5	5/16"	8,3	36	13	27	-	24	10	812.014.9*	5,1
M16 x 1,5	3/8"	10,2	35	12	27	-	24	10	812.016.9	4,8
M20 x 1,5	3/8"	10,2	36	13	27	-	24	10	812.017.9	5,1
M20 x 1,5	1/2"	13,9	37	13	30	-	27	10	812.020.9	5,9
M25 x 1,5	3/4"	18,5	40	15	36	-	36	5	812.025.9	7,9
M32 x 1,5	1"	23,8	46	15	46	-	46	5	812.032.9	17,5
M40 x 1,5	1.1/4"	31,8	52	16	54	-	52	2	812.040.9	27,9

* Fittings for 5/16" conduit without UL/CSA approval

ISO 45° fitting, male, stainless steel (AISI-304).

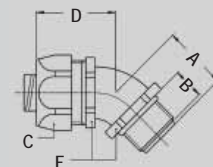

Thread ISO	Sealtite Size (inch)	Min. Internal Bore (mm)	Dimensions in mm					Standard Package	Article Number	Weight (Kg/100)
			A	B	C	D	E			
M16 x 1,5	5/16"	8,3	23	12	27	33	22	10	812.415.9*	7,3
M20 x 1,5	5/16"	8,3	24	13	27	33	22	10	812.414.9*	7,4
M16 x 1,5	3/8"	10,2	23	12	27	33	22	10	812.416.9	7,3
M20 x 1,5	3/8"	10,2	24	13	27	33	22	10	812.417.9	7,4
M20 x 1,5	1/2"	13,9	25	13	30	33	27	10	812.420.9	10,5
M25 x 1,5	3/4"	18,5	30	15	36	36	33	5	812.425.9	13,6

* Fittings for 5/16" conduit without UL/CSA approval.

ISO 90° fitting, male, stainless steel
(AISI-304).

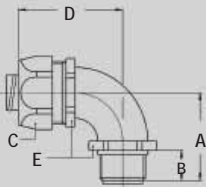

Thread	Sealtite Size (inch)	Min. Internal Bore (mm)	Dimensions in mm					Standard Package	Article Number	Weight (Kg/100)
			A	B	C	D	E			
M16 x 1,5	5/16"	8,3	32	12	27	42	22	10	812.915.9*	8,2
M20 x 1,5	5/16"	8,3	33	13	27	42	22	10	812.914.9*	8,4
M16 x 1,5	3/8"	10,2	32	12	27	42	22	10	812.916.9	8,2
M20 x 1,5	3/8"	10,2	33	13	27	42	22	10	812.917.9	8,4
M20 x 1,5	1/2"	13,9	36	13	30	43	27	10	812.920.9	12,6
M25 x 1,5	3/4"	18,5	43	15	36	48	33	5	812.925.9	19,2

* Fittings for 5/16" conduit without UL/CSA approval.

ISO cable-hose fitting, male, stainless steel
(AISI-304).

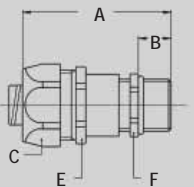

Thread	Sealtite Size (inch)	Clamping Range (mm)	Dimensions in mm						Standard Package	Article Number	Weight (Kg/100)
			A	B	C	E	F				
M16 x 1,5	5/16"	4 - 8	57	12	27	24	18	10	812.715.9*	7,8	
M16 x 1,5	3/8"	4 - 8	57	12	27	24	18	10	812.716.9	7,8	
M20 x 1,5	3/8"	6 - 10,2	57	12	27	24	22	10	812.717.9	9,5	
M20 x 1,5	1/2"	6 - 12	59	12	30	27	22	10	812.720.9	9,7	

* Fittings for 5/16" conduit.

Pg straight fitting, male, stainless steel
(AISI-304).

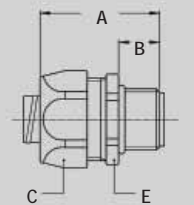

Thread	Sealtite Size (inch)	Min. Internal Bore (mm)	Dimensions in mm					Standard Package	Article Number	Weight (Kg/100)
			A	B	C	D	E			
Pg 11	5/16"	8,3	35	12	27	-	24	10	810.012.9*	5,6
Pg 13,5	5/16"	8,3	35	12	27	-	24	10	810.014.9*	5,6
Pg 11	3/8"	10,2	35	12	27	-	24	10	810.011.9	5,6
Pg 13,5	3/8"	10,2	35	12	27	-	24	10	810.013.9	5,6
Pg 16	1/2"	13,9	37	13	30	-	27	10	810.016.9	6,3
Pg 21	3/4"	18,5	40	15	36	-	36	5	810.021.9	8,4
Pg 29	1"	23,8	46	15	46	-	46	5	810.029.9	25,0
Pg 36	1.1/4"	31,8	52	16	54	-	52	2	810.036.9	34,6
Pg 42	1.1/2"	36,8	56	18	63	-	60	2	810.042.9	47,2
Pg 48	2"	47,8	66	20	77	-	74	2	810.048.9	72,0

* Fittings for 5/16" conduit without UL/CSA approval.

Pg 90° fitting, male, stainless steel
(AISI-304).

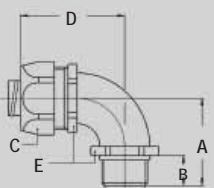

Thread	Sealtite Size (inch)	Min. Internal Bore (mm)	Dimensions in mm					Standard Package	Article Number	Weight (Kg/100)
			A	B	C	D	E			
Pg 11	5/16"	8,3	32	12	27	42	22	10	810.912.9*	8,9
Pg 11	3/8"	10,2	32	12	27	42	22	10	810.911.9	8,9
Pg 16	1/2"	13,9	36	13	30	43	27	10	810.916.9	15,3
Pg 21	3/4"	18,5	43	15	36	48	33	5	810.921.9	21,6
Pg 29	1"	23,8	48	15	46	50	42	5	810.929.9	35,3

* Fittings for 5/16" conduit without UL/CSA approval.

ANACONDA
SEALTITE®
SPECIAL

LIQUID-TIGHT
FITTINGS FOR
SEALTITE
IP 67

NPT straight fitting, male, stainless steel (AISI-304).

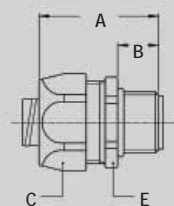

Thread NPT	Sealtite Size (inch)	Min. Internal Bore (mm)	Dimensions in mm					Standard Package	Article Number	Weight (Kg/100)
			A	B	C	D	E			
1/2" NPT	5/16"	8,3	37	13	27	-	24	10	814.011.9*	5,6
1/2" NPT	3/8"	10,2	37	13	27	-	24	10	814.012.9	5,6
1/2" NPT	1/2"	13,9	37	13	30	-	27	10	814.016.9	6,2
3/4" NPT	3/4"	18,5	40	15	36	-	36	5	814.020.9	8,9
1" NPT	1"	23,8	46	15	46	-	46	5	814.026.9	25,0

* Fittings for 5/16" conduit without UL/CSA approval.

NPT 45° fitting, male, stainless steel (AISI-304).

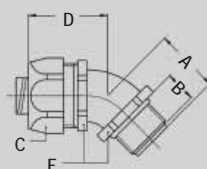

Thread NPT	Sealtite Size (inch)	Min. Internal Bore (mm)	Dimensions in mm					Standard Package	Article Number	Weight (Kg/100)
			A	B	C	D	E			
1/2" NPT	5/16"	8,3	25	13	27	33	22	10	814.411.9*	7,9
1/2" NPT	3/8"	10,2	25	13	27	33	22	10	814.412.9	7,9
1/2" NPT	1/2"	13,9	25	13	30	33	27	10	814.416.9	10,7
3/4" NPT	3/4"	18,5	30	15	36	36	33	5	814.420.9	15,7

* Fittings for 5/16" conduit without UL/CSA approval.

NPT 90° fitting, male, stainless steel (AISI-304).

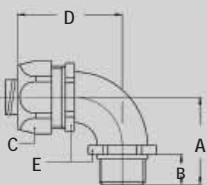

Thread NPT	Sealtite Size (inch)	Min. Internal Bore (mm)	Dimensions in mm					Standard Package	Article Number	Weight (Kg/100)
			A	B	C	D	E			
1/2" NPT	5/16"	8,3	36	13	27	43	22	10	814.911.9*	13,3
1/2" NPT	3/8"	10,2	36	13	27	43	22	10	814.912.9	13,3
1/2" NPT	1/2"	13,9	36	13	30	43	27	10	814.916.9	14,6
3/4" NPT	3/4"	18,5	43	15	36	48	33	5	814.920.9	22,0
1" NPT	1"	23,8	48	15	46	59	42	5	814.926.9	31,7

* Fittings for 5/16" conduit without UL/CSA approval.

Grounding ferrule, nickel plated brass.



Thread	Sealtite Size (inch)	Min. Internal Bore (mm)	Dimensions in mm					Standard Package	Article Number	Weight (Kg/100)
			A	B	C	D	E			
-	5/16"	8,3	-	-	-	-	-	10	815.010.0	0,8
-	3/8"	10,2	-	-	-	-	-	10	815.011.3	0,6
-	1/2"	13,9	-	-	-	-	-	10	815.016.3	0,8
-	3/4"	18,5	-	-	-	-	-	5	815.021.3	1,4
-	1"	23,8	-	-	-	-	-	5	815.029.3	2,8
-	1.1/4"	31,8	-	-	-	-	-	2	815.036.3	6,0
-	1.1/2"	36,8	-	-	-	-	-	2	815.042.3	6,8
-	2"	47,8	-	-	-	-	-	2	815.048.3	8,8

ANACONDA
SEALTITE®
SPECIAL

LIQUID-TIGHT
FITTINGS FOR
SEALTITE
IP 67



Anaconda stainless steel AISI-316 fittings for Anaconda Sealtite.

The stainless steel AISI-316 Anaconda fittings can be used with all types of Anaconda Sealtite (except CNP) and offer the highest corrosion resistance. These stainless steel Anaconda fittings are mostly used in the off-shore, chemical and food industry. Because of the UL & CSA approvals the fittings are also suitable for export projects outside Europe.

Material & Construction:

Construction: Stainless steel (AISI-316) fitting, consisting of 4 parts (counter nut, clamping ring, ferrule and body).

Material: Counter nut and body are stainless steel (AISI-316) and the ferrule is from nickel plated brass. Clamping

ring and insert are from PA6 (red for ISO metric and white for NPT).

Special approvals: UL-514B and CSA C 22.2 (combined UL/CSA file # E 234207).

Suitable for use in hazardous environments according NEC:

- Article 501.10 (B) (2) Class I, Division 2
- Article 502.10 (A) (2) and (B) (2) Class II, Division 1 and 2
- Article 503.10 (A) (3) and (B) Class III, Division 1 and 2

Temperature: -45 °C till +105 °C continuous.

Protection class: IP 67 (dust-proof, water-tight).

Colour: Metal.

**ANACONDA
SEALTITE®
SPECIAL**

**LIQUID-TIGHT
FITTINGS FOR
SEALTITE
IP 67**

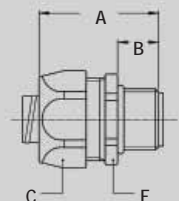

ISO straight fitting, male, stainless steel (AISI-316).



Thread	Sealtite Size (inch)	Min. Internal Bore (mm)	Dimensions in mm					Standard Package	Article Number	Weight (Kg/100)
			A	B	C	D	E			
M16 x 1,5	3/8"	10,2	35	12	26	-	24	10	812.116.9	4,8
M20 x 1,5	1/2"	13,9	37	13	29	-	27	10	812.120.9	5,9
M25 x 1,5	3/4"	18,5	40	15	35	-	33	5	812.125.9	7,9
M32 x 1,5	1"	23,8	46	15	45	-	43	5	812.132.9	17,5

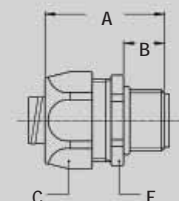

Pg straight fitting, male, stainless steel (AISI-316).



Thread	Sealtite Size (inch)	Min. Internal Bore (mm)	Dimensions in mm					Standard Package	Article Number	Weight (Kg/100)
			A	B	C	D	E			
Pg 16	1/2"	13,9	37	13	30	-	27	10	810.116.9	6,3
Pg 21	3/4"	18,5	40	15	36	-	36	5	810.121.9	8,4
Pg 29	1"	23,8	46	15	46	-	46	5	810.129.9	25,0

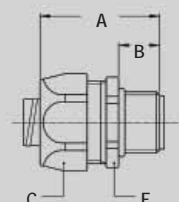

NPT straight fitting, male, stainless steel (AISI-316).



Thread	Sealtite Size (inch)	Min. Internal Bore (mm)	Dimensions in mm					Standard Package	Article Number	Weight (Kg/100)
			A	B	C	D	E			
1/2" NPT	3/8"	10,2	35	12	26	-	24	10	814.112.9	5,6
1/2" NPT	1/2"	13,9	37	13	29	-	27	10	814.116.9	6,2
3/4" NPT	3/4"	18,5	40	15	35	-	33	5	814.120.9	8,9
1" NPT	1"	23,8	46	15	45	-	43	5	814.126.9	25,0

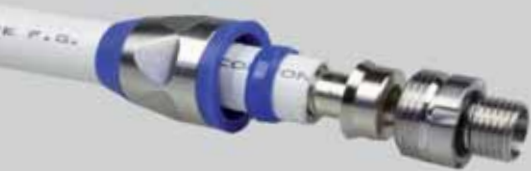

Anaconda Hygienic Design, stainless steel AISI-316 “food fitting” for Anaconda Sealtite.

Anaconda hygienically designed, stainless steel food fittings can be used with all types of Anaconda Sealtite conduits (except CNP). These stainless fittings are designed with rounded corners and have a smooth contourless profile to minimise the risk of bacteria deposits and to promote easy cleaning. They display excellent resistance to corrosion.

Material & Construction:

Construction: Stainless steel (AISI-316) fitting, consisting of 6 parts (lower seal, counter nut, upper seal, clamping ring, ferrule and body).

Material: Counter nut and body are stainless steel (AISI-316) and the ferrule is from nickel plated brass. Clamping



ring is from PA6. The blue rubber is made of TPE in accordance with FDA-CFR 21.

Special approvals: Special TPE seals, halogen-free, specially formulated for food and beverage applications per FDA guideline CFR 21.

Temperature: -45 °C till +105 °C continuous.

Protection class: IP 68 according EN 60529, IP69K according DIN 40050-9 (till 40 Bar high pressure).

Colour: Metal.

ISO straight food grade fitting, male, stainless steel (AISI-316).

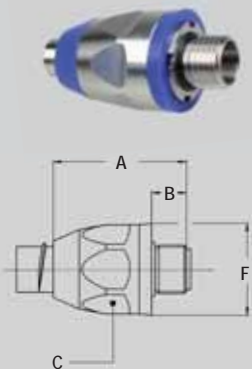

Thread	Sealtite Size (inch)	Min. Internal Bore (mm)	Dimensions in mm					Standard Package	Article Number	Weight (Kg/100)
			A	B	C	D	F			
M16 x 1,5	3/8"	10,4	48	12	27	-	31	10	832.016.9	6,6
M20 x 1,5	1/2"	13,8	50	13	30	-	34	10	832.020.9	8,0
M25 x 1,5	3/4"	18,5	57	15	36	-	41	5	832.025.9	11,8
M32 x 1,5	1"	23,8	68	15	46	-	53	5	832.032.9	22,8
M40 x 1,5	1.1/4"	31,8	75	16	54	-	62	2	832.040.9	34,2
M50 x 1,5	1.1/2"	36,8	81	18	63	-	70	1	832.050.9	38,6
M63 x 1,5	2"	47,8	88	20	77	-	85	1	832.063.9	76,6

ANACONDA
SEALTITE®
SPECIAL

LIQUID-TIGHT
FITTINGS FOR
SEALTITE
IP 68



Anaconda swivel fittings, stainless steel AISI-316 , for Anaconda Sealtite.

The swivel version stainless steel AISI-316 Anaconda fittings can be used with all types of Anaconda Sealtite (except CNP). This Anaconda fitting is a universal fitting with a special swivel mechanism for a higher tensile strength and a high water proof protection (IP67). All ferrules are turned nickel plated brass versions for a better fit. The high quality stainless steel AISI-316 offers a superb corrosion protection in combination with a nice appearance.



Construction: Stainless steel AISI-316 fitting, consisting of 4 parts (counter nut, clamping ring, ferrule and body).

Material: Counter nut and body are stainless steel AISI-316. Clamping ring is made from PA6 and the ferrule is made from nickel plated brass. The O-rings are from NBR rubber (black for ISO).

Temperature: -45 °C till +105 °C continuous

Protection class: IP 67

Colour: Metal

ANACONDA COMPACT FITTINGS

LIQUID-TIGHT FITTINGS FOR SEALTITE IP 67

NPT 45° swivel fitting, male, stainless steel (AISI-316).

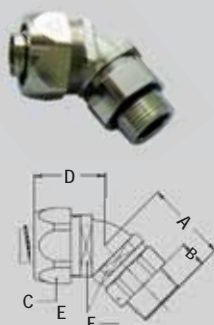

Thread	Sealtite Size (inch)	Min. Internal Bore (mm)	Dimensions in mm						Standard Package	Article Number	Weight (Kg/100)
			A	B	C	D	E	F			
NPT 1/2"	3/8"	10,4	36	12	27	28	22	22	10	819.212.9	11,5
NPT 1/2"	1/2"	13,8	36	12	30	30	27	25	10	819.216.9	14,0
NPT 3/4"	3/4"	17,4	-	12	36	-	-	-	5	838.220.9	22,0
NPT 1"	1"	23,4	-	13	46	-	-	-	5	838.226.9	37,0

NPT 90° swivel fitting, male, stainless steel (AISI-316).



Thread	Sealtite Size (inch)	Min. Internal Bore (mm)	Dimensions in mm						Standard Package	Article Number	Weight (Kg/100)
			A	B	C	D	E	F			
NPT 1/2"	3/8"	10,4	41	12	27	35	22	22	10	819.512.9	12,0
NPT 1/2"	1/2"	13,8	41	12	30	37	27	25	10	819.516.9	14,0
NPT 3/4"	3/4"	17,4	-	12	36	-	-	-	5	838.520.9	23,5
NPT 1"	1"	23,4	-	13	46	-	-	-	5	838.526.9	42,0



Neoprene Sealing gasket for ISO



Thread	Thread	Thread	Dimensions in mm					Standard	Article	Weight
ISO	Pg	NPT	A	B	C	D	E	Package	Number	(Kg/100)
M16 x 1,5	-	-	1,2	-	20	14	-	100	815.416.0	0,03
M20 x 1,5	-	-	1,2	-	24	18	-	100	815.420.0	0,03
M25 x 1,5	-	-	1,2	-	30	23	-	50	815.425.0	0,05
M32 x 1,5	-	-	1,2	-	40	30	-	50	815.432.0	0,11
M40 x 1,5	-	-	1,2	-	48	38	-	50	815.440.0	0,15
M50 x 1,5	-	-	1,2	-	58	48	-	50	815.450.0	0,19
M63 x 1,5	-	-	1,2	-	75	61	-	50	815.463.0	0,33



Neoprene Sealing gasket for Pg / NPT.



Thread	Thread	Thread	Dimensions in mm					Standard	Article	Weight
ISO	Pg	NPT	A	B	C	D	E	Package	Number	(Kg/100)
-	Pg 7	-	1,2	-	17	11,5	-	100	815.507.0	0,03
-	Pg 9	-	1,2	-	20	14	-	100	815.509.0	0,03
-	Pg 11	-	1,2	-	23	17	-	100	815.511.0	0,03
-	Pg 13,5	-	1,2	-	25	19	-	100	815.513.0	0,04
-	Pg 16	NPT 1/2"	1,2	-	27	21	-	100	815.516.0	0,05
-	Pg 21	NPT 3/4"	1,2	-	34	26,5	-	50	815.521.0	0,07
-	Pg 29	NPT 1"	1,2	-	45	35	-	50	815.529.0	0,13
-	Pg 36	NPT 1.1/4"	1,2	-	56	45	-	50	815.536.0	0,19
-	Pg 42	NPT 1.1/2"	1,2	-	67	52	-	50	815.542.0	0,30
-	Pg 48	NPT 2"	1,2	-	72	58	-	50	815.548.0	0,34

ANACONDA FITTINGS



NPT flatseal, NBR Rubber



Thread	Sealite	Min. Internal	Dimensions in mm					Standard	Article	Weight
	Size (inch)	Bore (mm)	A	B	C	D	E	Package	Number	(Kg/100)
NPT 1/2"	1/2"	-	-	-	-	-	-	50	815.616.0	0,03
NPT 3/4"	3/4"	-	-	-	-	-	-	25	815.620.0	0,05
NPT 1"	1"	-	-	-	-	-	-	25	815.626.0	0,11
NPT 1.1/4"	1.1/4"	-	-	-	-	-	-	10	815.635.0	0,15
NPT 1.1/2"	1.1/2"	-	-	-	-	-	-	10	815.640.0	0,19
NPT 2"	2"	-	-	-	-	-	-	10	815.650.0	0,33

ACCESSORIES



Lock nuts, nickel plated brass, ISO.



Thread ISO	Seallite Size (inch)	Min. Internal Bore (mm)	Dimensions in mm					Standard Package	Article Number	Weight (Kg/100)
			A	B	C	D	E			
M12 x 1,5	-	-	3,0	-	15	-	-	50	880.112.0	0,3
M16 x 1,5	-	-	2,8	-	19	-	-	50	880.116.0	0,4
M20 x 1,5	-	-	3,5	-	24	-	-	50	880.120.0	0,6
M25 x 1,5	-	-	3,5	-	30	-	-	25	880.125.0	0,9
M32 x 1,5	-	-	4,5	-	35	-	-	20	880.132.0	2,2
M40 x 1,5	-	-	4,5	-	45	-	-	10	880.140.0	3,2
M50 x 1,5	-	-	5,5	-	55	-	-	10	880.150.0	5,0
M63 x 1,5	-	-	6,0	-	70	-	-	5	880.163.0	5,6



Lock nuts, nickel plated brass, Pg.



Thread Pg	Seallite Size (inch)	Min. Internal Bore (mm)	Dimensions in mm					Standard Package	Article Number	Weight (Kg/100)
			A	B	C	D	E			
Pg 7	-	-	2,9	-	15	-	-	50	880.007.0	0,2
Pg 9	-	-	2,9	-	18	-	-	50	880.009.0	0,2
Pg 11	-	-	2,9	-	21	-	-	50	880.011.0	0,3
Pg 13,5	-	-	3,1	-	23	-	-	50	880.013.0	0,4
Pg 16	-	-	3,1	-	26	-	-	50	880.016.0	0,5
Pg 21	-	-	3,6	-	32	-	-	20	880.021.0	0,8
Pg 29	-	-	4,1	-	41	-	-	20	880.029.0	1,4
Pg 36	-	-	5,1	-	51	-	-	10	880.036.0	2,1
Pg 42	-	-	5,1	-	60	-	-	5	880.042.0	3,6
Pg 48	-	-	5,6	-	64	-	-	5	880.048.0	4,1



Lock nuts, nickel plated brass, NPT.



Thread NPT	Seallite Size (inch)	Min. Internal Bore (mm)	Dimensions in mm					Standard Package	Article Number	Weight (Kg/100)
			A	B	C	D	E			
NPT 1/2"	-	-	5,0	-	24	-	-	50	880.216.0	0,9
NPT 3/4"	-	-	7,0	-	30	-	-	20	880.220.0	1,9
NPT 1"	-	-	7,0	-	36	-	-	20	880.226.0	2,3
NPT 1.1/4"	-	-	-	-	-	-	-	20	880.235.0	3,4
NPT 1.1/2"	-	-	-	-	-	-	-	10	880.240.0	4,4
NPT 2"	-	-	-	-	-	-	-	10	880.250.0	5,4



NPT locknut, galvanised steel



Thread	Seallite Size (inch)	Min. Internal Bore (mm)	Dimensions in mm					Standard Package	Article Number	Weight (Kg/100)
			A	B	C	D	E			
NPT 1/2"	1/2"	-	-	-	-	-	-	100	880.316.0	0,5
NPT 3/4"	3/4"	-	-	-	-	-	-	50	880.320.0	0,8
NPT 1"	1"	-	-	-	-	-	-	50	880.326.0	1,3
NPT 1.1/4"	1.1/4"	-	-	-	-	-	-	20	880.335.0	1,8
NPT 1.1/2"	1.1/2"	-	-	-	-	-	-	20	880.340.0	2,2
NPT 2"	2"	-	-	-	-	-	-	20	880.350.0	2,8

Pg / Pg enlargers, nickel plated brass.

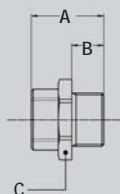

Outside Thread	Inside Thread	Min. Internal Bore (mm)	Dimensions in mm					Standard Package	Article Number	Weight (Kg/100)
			A	B	C	D	E			
Pg 7	Pg 9	-	15	5	17	-	-	50	882.009.0	0,7
Pg 9	Pg 11	-	16,5	6	20	-	-	50	882.011.0	0,9
Pg 9	Pg 13,5	-	17,5	6	22	-	-	50	882.012.0	1,1
Pg 11	Pg 13,5	-	17,5	6	22	-	-	50	882.013.0	1,2
Pg 11	Pg 16	-	19	6,5	24	-	-	25	882.016.0	1,2
Pg 13,5	Pg 16	-	18,5	6	24	-	-	25	882.017.0	1,3
Pg 13,5	Pg 21	-	21	6,5	30	-	-	20	882.018.0	2,3
Pg 16	Pg 21	-	21	6,5	30	-	-	20	882.021.0	2,4
Pg 21	Pg 29	-	23	7	39	-	-	15	882.029.0	3,7
Pg 29	Pg 36	-	28	8	50	-	-	10	882.036.0	7,4
Pg 36	Pg 42	-	31	9	57	-	-	10	882.042.0	9,3
Pg 42	Pg 48	-	33	10	64	-	-	10	882.048.0	14,7

ANACONDA FITTINGS

Pg / ISO adapter, nickel plated brass.



A



B

Outside Thread	Inside Thread	Type	Dimensions in mm					Standard Package	Article Number	Weight (Kg/100)
			A	B	C	D	E			
Pg 11	M16 x 1,5	A	11	6,5	22	-	-	50	882.111.0	1,3
Pg 16	M20 x 1,5	A	16	7	27	-	-	50	882.116.0	3,2
Pg 21	M25 x 1,5	B	13	8	32	-	-	20	882.121.0	3,8
Pg 29	M32 x 1,5	B	14	8,5	40	-	-	20	882.129.0	8,0
Pg 36	M40 x 1,5	B	15	8,5	55	-	-	10	882.136.0	12,4
Pg 48	M50 x 1,5	B	17	10	65	-	-	5	882.148.0	17,2

ACCESSORIES

Pg / Pg reducer, nickel plated brass.

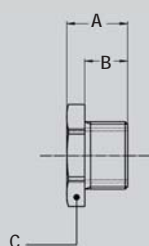

Outside Thread	Inside Thread	Min. Internal Bore (mm)	Dimensions in mm					Standard Package	Article Number	Weight (Kg/100)
			A	B	C	D	E			
Pg 9	Pg 7	-	8	5	17	-	-	100	881.007.0	0,4
Pg 11	Pg 7	-	9	6	19	-	-	100	881.008.0	0,7
Pg 11	Pg 9	-	9	6	19	-	-	100	881.009.0	0,9
Pg 13,5	Pg 9	-	9	6	21	-	-	100	881.010.0	0,9
Pg 13,5	Pg 11	-	9	6	21	-	-	100	881.011.0	0,9
Pg 16	Pg 11	-	9	6	23	-	-	100	881.012.0	0,9
Pg 16	Pg 13,5	-	9	6	23	-	-	100	881.013.0	1,2
Pg 21	Pg 13,5	-	10	7	29	-	-	50	881.015.0	2,1
Pg 21	Pg 16	-	10	7	29	-	-	50	881.016.0	1,8
Pg 29	Pg 21	-	11	8	39	-	-	25	881.021.0	3,7
Pg 36	Pg 29	-	11	8	50	-	-	25	881.029.0	5,7
Pg 42	Pg 36	-	14	10	64	-	-	25	881.036.0	6,5
Pg 48	Pg 42	-	14	10	64	-	-	25	881.042.0	7,7