

Die schnell schließenden Verschraubungen der Serie AR ermöglichen eine sichere und wirtschaftliche Verbindung mit den verzinkten Stahlrohren STD und reduzieren die Dauer der Installation. Die spezielle Konstruktion ermöglicht eine schnelle Abnahme ohne Kraftaufwand und Werkzeugen. /

The fast closing glands of series AR enable safe and economic connection with the zinc-plated steel tubes STD and reduce as well the duration of installation. The special design allows rapid take-off without effort or tools.

Material / material: Messing / brass  
Schutzart / protection grade: IP67

IP67



## GOGACON ARM schnell schließende Verschr. Außengewinde / quick-lock gland with outside thread

| Typ    | Rohr-Ø | Gewinde | Abmessungen mm |      |    | Innen-Ø mm  | VPE  | ArtNr     | €     |
|--------|--------|---------|----------------|------|----|-------------|------|-----------|-------|
| type   | tube-Ø | thread  | CH1            | LR   | LF | P           | Stk. |           | /Stk. |
|        |        |         | dimensions mm  |      |    | inside-Ø mm | PU   |           | /pc.  |
| ARM16M | 16     | M16x1,5 | 24             | 25   | 10 | 11,0        | 20   | 32-ARM16M | 4,81  |
| ARM20M | 20     | M20x1,5 | 28             | 25   | 10 | 15,5        | 20   | 32-ARM20M | 6,14  |
| ARM25M | 25     | M25x1,5 | 33             | 26   | 10 | 20,0        | 10   | 32-ARM25M | 9,31  |
| ARM32M | 32     | M32x1,5 | 40             | 27   | 14 | 26,5        | 10   | 32-ARM32M | 11,11 |
| ARM40M | 40     | M40x1,5 | 50             | 33   | 15 | 35,0        | 5    | 32-ARM40M | 15,96 |
| ARM50M | 50     | M50x1,5 | 60             | 33   | 15 | 42,0        | 5    | 32-ARM50M | 21,65 |
| ARM16  | 16     | 1/2"    | 24             | 25   | 10 | 14,0        | 20   | 32-ARM16  | 4,81  |
| ARM20  | 20     | 1/2"    | 28             | 25   | 10 | 15,0        | 20   | 32-ARM20  | 6,14  |
| ARM20A | 20     | 3/4"    | 28             | 25   | 10 | 18,0        | 20   | 32-ARM20A | 6,78  |
| ARM25  | 25     | 3/4"    | 33             | 26   | 10 | 20,0        | 10   | 32-ARM25  | 8,46  |
| ARM25A | 25     | 1"      | 35             | 27   | 12 | 23,0        | 10   | 32-ARM25A | 8,87  |
| ARM32  | 32     | 1"      | 40             | 27   | 14 | 26,5        | 10   | 32-ARM32  | 11,11 |
| ARM40  | 40     | 1" 1/4" | 50             | 33   | 15 | 35,0        | 5    | 32-ARM40  | 15,96 |
| ARM50  | 50     | 1" 1/2" | 60             | 33   | 15 | 40,0        | 5    | 32-ARM50  | 21,65 |
| ARM50A | 50     | 2"      | 64             | 32,5 | 15 | 47,0        | 2    | 32-ARM50A | 27,19 |

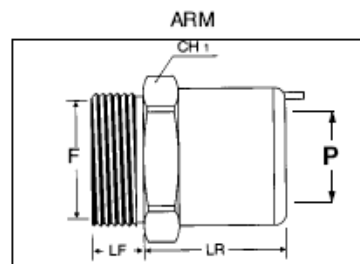

## GOGACON ARF schnell schließende Verschr. Innengewinde / quick-lock gland with inside thread

| Typ    | Rohr-Ø | Gewinde | Abmessungen mm |      |    | Innen-Ø mm  | VPE  | ArtNr     | €     |
|--------|--------|---------|----------------|------|----|-------------|------|-----------|-------|
| type   | tube-Ø | thread  | CH1            | LR   | LF | P           | Stk. |           | /Stk. |
|        |        |         | dimensions mm  |      |    | inside-Ø mm | PU   |           | /pc.  |
| ARF16M | 16     | M16x1,5 | 24             | 25   | 10 | 14,0        | 20   | 32-ARF16M | 5,27  |
| ARF20M | 20     | M20x1,5 | 28             | 25   | 10 | 18,0        | 20   | 32-ARF20M | 6,14  |
| ARF25M | 25     | M25x1,5 | 33             | 26   | 10 | 22,5        | 10   | 32-ARF25M | 9,31  |
| ARF32M | 32     | M32x1,5 | 40             | 27   | 14 | 29,0        | 10   | 32-ARF32M | 10,47 |
| ARF40M | 40     | M40x1,5 | 50             | 33   | 15 | 37,5        | 5    | 32-ARF40M | 18,43 |
| ARF50M | 50     | M50x1,5 | 60             | 33   | 15 | 47,0        | 5    | 32-ARF50M | 25,04 |
| ARF16  | 16     | 1/2"    | 24             | 25   | 10 | 14,0        | 20   | 32-ARF16  | 5,27  |
| ARF20  | 20     | 3/4"    | 28             | 25   | 10 | 18,0        | 20   | 32-ARF20  | 6,14  |
| ARF25  | 25     | 3/4"    | 33             | 26   | 10 | 22,5        | 10   | 32-ARF25  | 8,46  |
| ARF32  | 32     | 1"      | 40             | 27   | 14 | 29,5        | 10   | 32-ARF32  | 10,47 |
| ARF40  | 40     | 1" 1/4" | 50             | 33   | 15 | 37,0        | 5    | 32-ARF40  | 18,43 |
| ARF50  | 50     | 1" 1/2" | 60             | 33   | 15 | 42,5        | 5    | 32-ARF50  | 25,04 |
| ARF50A | 50     | 2"      | 64             | 33,5 | 16 | 47,0        | 2    | 32-ARF50A | 29,51 |

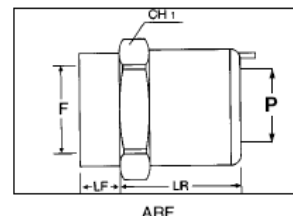

Preise gültig ab 01.07.2021 exkl. MwSt., freibleibend, Auftragsrabatt auf Anfrage /  
prices are valid from 01.07.2021 excl. VAT, subject to change, discounts upon request  
sonst. Konditionen siehe [www.gogatec.com/AGB.pdf](http://www.gogatec.com/AGB.pdf), techn. Änderungen vorbehalten /  
terms & conditions can be found on our website: [www.gogatec.com/AGB.pdf](http://www.gogatec.com/AGB.pdf); error, technical modifications and variations are reserved



## GOGACON ARG Messing Rohr zu Rohr Verschraubungen / brass gland tube to tube

Material: Messing / brass

| Typ   | Rohr- $\phi$ | Außen- $\phi$   | Pass-<br>länge | Innen- $\phi$  | VPE | ArtNr    | €             |
|-------|--------------|-----------------|----------------|----------------|-----|----------|---------------|
| type  | tube- $\phi$ | outside- $\phi$ | fitting length | inside- $\phi$ | PU  |          | /Stk.<br>/pc. |
| ARG16 | 16           | 24              | 53,5           | 14             | 10  | 32-ARG16 | 7,66          |
| ARG20 | 20           | 28              | 53,5           | 18             | 10  | 32-ARG20 | 8,63          |
| ARG25 | 25           | 33              | 56             | 23             | 10  | 32-ARG25 | 10,83         |
| ARG32 | 32           | 40              | 56             | 30             | 5   | 32-ARG32 | 14,93         |
| ARG40 | 40           | 50              | 70             | 37,5           | 5   | 32-ARG40 | 22,05         |
| ARG50 | 50           | 60              | 70             | 47,5           | 2   | 32-ARG50 | 31,21         |

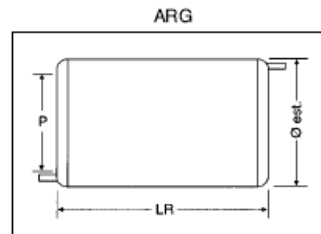

## GOGACON ARFR Einfache Rohr-zu-Schlauch-Verschraubungen / brass gland tube to conduit

Passende Schläuche auf Anfrage / according conduits upon request

Material: Messing / brass

| Typ     | Rohr- $\phi$ | Schlauch<br>Nennweite | messungen r              | Außen- $\phi$         | Innen- $\phi$       | VPE        | ArtNr      | €             |
|---------|--------------|-----------------------|--------------------------|-----------------------|---------------------|------------|------------|---------------|
| type    | tube- $\phi$ | conduit nominal size  | CH1 CH2<br>dimensions mm | mm<br>outside- $\phi$ | P<br>inside- $\phi$ | Stk.<br>PU |            | /Stk.<br>/pc. |
| ARFR163 | 16           | 12                    | 24 26                    | 24                    | 10,5                | 20         | 32-ARFR163 | 8,04          |
| ARFR16  | 16           | 15                    | 28 30                    | 24                    | 14,0                | 20         | 32-ARFR16  | 8,51          |
| ARFR20  | 20           | 15                    | 28 30                    | 28                    | 14,0                | 20         | 32-ARFR20  | 9,22          |
| ARFR20A | 20           | 20                    | 35 38                    | 28                    | 18,0                | 10         | 32-ARFR20A | 11,87         |
| ARFR25  | 25           | 20                    | 35 38                    | 33                    | 18,5                | 10         | 32-ARFR25  | 12,77         |
| ARFR25A | 25           | 25                    | 40 42                    | 33                    | 22,5                | 10         | 32-ARFR25A | 13,96         |
| ARFR25B | 25           | 27                    | 42 45                    | 33                    | 22,5                | 10         | 32-ARFR25B | 14,72         |
| ARFR32  | 32           | 27                    | 42 45                    | 40                    | 25,0                | 5          | 32-ARFR32  | 16,79         |
| ARFR32A | 32           | 33                    | 50 53                    | 40                    | 29,5                | 5          | 32-ARFR32A | 23,30         |
| ARFR32B | 32           | 35                    | 50 53                    | 40                    | 32,5                | 5          | 32-ARFR32B | 24,15         |
| ARFR40  | 40           | 33                    | 50 53                    | 50                    | 31,0                | 5          | 32-ARFR40  | 25,70         |
| ARFR40A | 40           | 35                    | 50 53                    | 50                    | 23,5                | 5          | 32-ARFR40A | 28,19         |
| ARFR40B | 40           | 40                    | 58 61                    | 50                    | 37,5                | 5          | 32-ARFR40B | 34,13         |
| ARFR50  | 50           | 50                    | 70 74                    | 60                    | 47,0                | 2          | 32-ARFR50  | 45,96         |
| ARFR50A | 50           | 40                    | 60 61                    | 60                    | 37,5                | 2          | 32-ARFR50A | 41,58         |

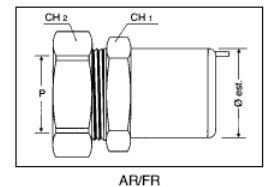

## GOGACON PA-K7-SR Schlauch-Rohrverbinder IP68 / conduit-tubular connector IP68

Material: Polyamid PA6

Schutzart / protection grade: IP66/68

Temperaturbereich / temperature range: -40°C - +105°C kurzzeitig / temporarily bis +150°

| Typ         | Nennweite    | Stahl-Rohr | Länge  | VPE | ArtNr                      | €             |
|-------------|--------------|------------|--------|-----|----------------------------|---------------|
| type        | nominal size | steel-tube | length | PU  | schwarz IP68<br>black IP68 | /Stk.<br>/pc. |
| PA-K7-SR 12 | 12           | 16         | 60,9   | 50  | 245492SW-68                | 13,67         |
| PA-K7-SR 17 | 17           | 20         | 61,9   | 50  | 245493SW-68                | 16,17         |
| PA-K7-SR 23 | 23           | 25         | 72,0   | 30  | 245494SW-68                | 19,23         |
| PA-K7-SR 29 | 29           | 32         | 72,5   | 20  | 245495SW-68                | 22,29         |
| PA-K7-SR 36 | 36           | 40         | 86,0   | 20  | 245496SW-68                | 40,36         |
| PA-K7-SR 48 | 48           | 50         | 92,5   | 10  | 245497SW-68                | 48,61         |



Preise gültig ab 01.07.2021 exkl. MwSt., freibleibend, Auftragsrabatt auf Anfrage /

prices are valid from 01.07.2021 excl. VAT, subject to change, discounts upon request

sonst. Konditionen siehe [www.gogatec.com/AGB.pdf](http://www.gogatec.com/AGB.pdf), techn. Änderungen vorbehalten /

terms & conditions can be found on our website: [www.gogatec.com/AGB.pdf](http://www.gogatec.com/AGB.pdf); error, technical modifications and variations are reserved

Neben der guten Verbindung der Verschraubung und dem Rohr, ist es auch notwendig eine hohe Festigkeit und Isolierung im Falle einer Beanspruchung oder ruckartigen Bewegung zu gewährleisten. / As well as secure anchoring of the gland and the tube, it is also necessary to guarantee solidity and insulation for the electric continuity of the couple.

Die sichere Fixierung der Verschraubung mit dem Rohr ist garantiert und unterscheidet sich in ihrer Effizienz weitgehend von den anderen AR-Verschraubungen. Der Dichtgummi verhindert das Eindringen von Wasser und Staub und gewährleistet somit eine Schutzart von IP67 und einen mechanischen Schutz gegen Stöße etc. /

The secure connection of gland and tube is guaranteed by the efficiency that distinguishes all the fitments in the AR range and further by the special plasticised pressure washer which assures the couple impermeable both to water and dust and provides mechanical protection against jerks and traction on the pipe itself.



GOGATEC ARPR Kombinierte Rohr- / Kabelverschraubung / combined tubular- & cable gland

Material / material: Messing / brass

Schutzart / protection grade: IP67

| Typ<br>type | Kabel-Ø mm<br>cable-Ø mm |      | Rohr-Ø<br>tube-Ø | Gewinde<br>thread | Abmessungen mm<br>dimensions mm |     |      | ArtNr          | €/Stk.<br>/pc. |
|-------------|--------------------------|------|------------------|-------------------|---------------------------------|-----|------|----------------|----------------|
|             | von                      | bis  |                  |                   | CH1                             | CH2 | LF   |                |                |
| ARPR1606M16 | 4                        | 6,5  | 16               |                   | 24                              | 19  | 8    | 32-ARPR1606M16 | 11,40          |
| ARPR1608M16 | 5                        | 8,0  | 16               | M16x1,5           | 24                              | 19  | 8    | 32-ARPR1608M16 | 11,40          |
| ARPR1609M16 | 6,5                      | 9,5  | 16               |                   | 24                              | 19  | 8    | 32-ARPR1609M16 | 11,40          |
| ARPR2007M20 | 4                        | 6,5  | 20               |                   | 28                              | 24  | 8    | 32-ARPR2007M20 | 14,38          |
| ARPR2008M20 | 5                        | 8,0  | 20               |                   | 28                              | 24  | 8    | 32-ARPR2008M20 | 14,38          |
| ARPR2009M20 | 6,5                      | 9,5  | 20               | M20x1,5           | 28                              | 24  | 8    | 32-ARPR2009M20 | 14,38          |
| ARPR2011M20 | 7                        | 10,5 | 20               |                   | 28                              | 24  | 8    | 32-ARPR2011M20 | 14,38          |
| ARPR2013M20 | 9                        | 13,0 | 20               |                   | 28                              | 24  | 8    | 32-ARPR2013M20 | 14,38          |
| ARPR2518M25 | 14                       | 18,0 | 25               | M25x1,5           | 33                              | 30  | 9    | 32-ARPR2518M25 | 21,79          |
| ARPR2520M25 | 17                       | 20,5 | 25               |                   | 33                              | 30  | 9    | 32-ARPR2520M25 | 21,79          |
| ARPR3225M32 | 20                       | 25,0 | 32               | M32x1,5           | 40                              | 40  | 10   | 32-ARPR3225M32 | 28,40          |
| ARPR4030M40 | 26                       | 30,0 | 40               | M40x1,5           | 50                              | 45  | 10,5 | 32-ARPR4030M40 | 42,19          |
| ARPR5034M50 | 29                       | 34,0 | 50               | M50x1,5           | 60                              | 52  | 12   | 32-ARPR5034M50 | 58,40          |
| ARPR5036M50 | 32                       | 36,0 | 50               |                   | 60                              | 52  | 12   | 32-ARPR5036M50 | 58,40          |

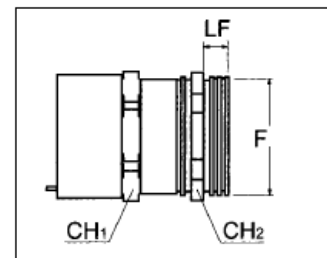

Preise gültig ab 01.07.2021 exkl. MwSt., freibleibend, Auftragsrabatt auf Anfrage / prices are valid from 01.07.2021 excl. VAT, subject to change, discounts upon request  
sonst. Konditionen siehe [www.gogatec.com/AGB.pdf](http://www.gogatec.com/AGB.pdf), techn. Änderungen vorbehalten / terms & conditions can be found on our website: [www.gogatec.com/AGB.pdf](http://www.gogatec.com/AGB.pdf); error, technical modifications and variations are reserved

Die Verschraubungen der Serie ES ermöglichen eine sichere und wirtschaftliche Verbindung mit den verzinkten Stahlrohren STD ohne ein Gewinde schneiden zu müssen. /  
The glands of series AR enable safe and economic connection with the zinc-plated steel tubes STD without need to cut a thread.

Sie zeichnen sich durch hervorragenden mechanischen Halt unter groben Bedingungen aus und bieten durch ihre spezielle Dichtung eine Schutzart von IP 67. /  
They are characterized by excellent mechanical traction under extreme conditions. Due to the special sealing they offer a protection-grade of IP67.

Material / material: Messing / brass  
Schutzart / protection grade: IP67

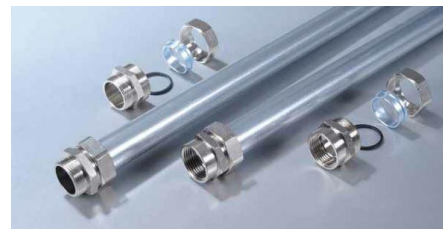

**GOGACON ESM Verschraubung Außengewinde / glands outside thread**

| Typ    | Rohr-Ø<br>mm | Gewinde messungen r |               | Innen-Ø mm  | VPE | Stk.      | ArtNr | €/Stk. |
|--------|--------------|---------------------|---------------|-------------|-----|-----------|-------|--------|
|        |              | F                   | CH1 CH2       |             |     |           |       |        |
| type   | tube-Ø       | thread              | dimensions mm | inside-Ø mm | PU  |           |       | /pc.   |
| ESM16M | 16           | 16x1,5              | 22 24         | 11,0        | 20  | 32-ESM16M | 3,89  |        |
| ESM20M | 20           | 20x1,5              | 26 28         | 16,0        | 20  | 32-ESM20M | 4,81  |        |
| ESM25M | 25           | 25x1,5              | 32 34         | 20,0        | 10  | 32-ESM25M | 7,98  |        |
| ESM32M | 32           | 32x1,5              | 40 42         | 26,5        | 10  | 32-ESM32M | 9,64  |        |
| ESM40M | 40           | 40x1,5              | 47 50         | 35,0        | 5   | 32-ESM40M | 13,00 |        |
| ESM50M | 50           | 50x1,5              | 58 61         | 45,0        | 5   | 32-ESM50M | 18,05 |        |
| ESM20  | 20           | PG16                | 26 28         | 18,0        | 20  | 32-ESM20  | 4,81  |        |
| ESM25  | 25           | PG21                | 32 34         | 22,5        | 10  | 32-ESM25  | 7,98  |        |
| ESM16  | 16           | 1/2"                | 22 24         | 14,0        | 20  | 32-ESM16  | 3,89  |        |
| ESM20A | 20           | 1/2"                | 26 28         | 15,0        | 20  | 32-ESM20A | 4,81  |        |
| ESM20B | 20           | 3/4"                | 30 28         | 18,0        | 20  | 32-ESM20B | 5,45  |        |
| ESM25A | 25           | 3/4"                | 32 34         | 21,0        | 10  | 32-ESM25A | 7,98  |        |
| ESM25B | 25           | 1"                  | 36 34         | 22,5        | 10  | 32-ESM25B | 8,39  |        |
| ESM32  | 32           | 1"                  | 40 42         | 27,0        | 10  | 32-ESM32  | 9,64  |        |
| ESM40  | 40           | 1" 1/4"             | 47 50         | 35,0        | 5   | 32-ESM40  | 13,00 |        |
| ESM50  | 50           | 1" 1/2"             | 58 61         | 39,0        | 5   | 32-ESM50  | 18,05 |        |
| ESM50A | 50           | 2"                  | 64 61         | 47,5        | 2   | 32-ESM50A | 25,81 |        |
| ESM60  | 60           | 2"                  | 70 74         | 52,0        | 2   | 32-ESM60  | 30,91 |        |

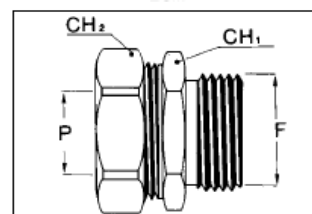

**GOGACON ESF Verschraubung Innengewinde / glands inside thread**

| Typ    | Rohr-Ø<br>mm | Gewinde<br>F | Abmessungen mm |             | Innen-Ø mm | VPE | Stk.      | ArtNr | €/Stk. |
|--------|--------------|--------------|----------------|-------------|------------|-----|-----------|-------|--------|
|        |              |              | CH1            | CH2         |            |     |           |       |        |
| type   | tube-Ø       | thread       | dimensions mm  | inside-Ø mm | PU         |     |           |       | /pc.   |
| ESF16M | 16           | 16x1,5       | 22             | 24          | 14,0       | 20  | 32-ESF16M | 3,89  |        |
| ESF20M | 20           | 20x1,5       | 26             | 28          | 18,0       | 20  | 32-ESF20M | 4,81  |        |
| ESF25M | 25           | 25x1,5       | 32             | 34          | 22,5       | 10  | 32-ESF25M | 7,98  |        |
| ESF32M | 32           | 32x1,5       | 40             | 42          | 29,5       | 10  | 32-ESF32M | 12,34 |        |
| ESF40M | 40           | 40x1,5       | 50             | 50          | 37,5       | 5   | 32-ESF40M | 13,86 |        |
| ESF50M | 50           | 50x1,5       | 58             | 61          | 42,5       | 5   | 32-ESF50M | 19,42 |        |
| ESF16  | 16           | 1/2"         | 22             | 24          | 14,0       | 20  | 32-ESF16  | 4,17  |        |
| ESF20  | 20           | 1/2"         | 26             | 28          | 18,0       | 20  | 32-ESF20  | 4,81  |        |
| ESF25  | 25           | 3/4"         | 32             | 34          | 22,5       | 10  | 32-ESF25  | 7,98  |        |
| ESF32  | 32           | 1"           | 40             | 42          | 27,0       | 10  | 32-ESF32  | 12,34 |        |
| ESF40  | 40           | 1" 1/4"      | 50             | 50          | 37,5       | 5   | 32-ESF40  | 13,86 |        |
| ESF50  | 50           | 1" 1/2"      | 58             | 61          | 42,0       | 5   | 32-ESF50  | 19,42 |        |
| ESF50A | 50           | 2"           | 64             | 61          | 47,5       | 2   | 32-ESF50A | 26,08 |        |
| ESF60  | 60           | 2"           | 71             | 74          | 56,0       | 2   | 32-ESF60  | 30,91 |        |

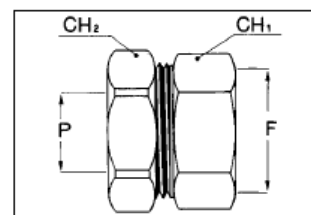

Preise gültig ab 01.07.2021 exkl. MwSt., freibleibend, Auftragsrabatt auf Anfrage /  
prices are valid from 01.07.2021 excl. VAT, subject to change, discounts upon request  
sonst. Konditionen siehe [www.gogatec.com/AGB.pdf](http://www.gogatec.com/AGB.pdf), techn. Änderungen vorbehalten /  
terms & conditions can be found on our website: [www.gogatec.com/AGB.pdf](http://www.gogatec.com/AGB.pdf); error, technical modifications and variations are reserved



IP67

## GOGACON ES schnell schließende Rohr - Rohr Verschr. / quick-locking tube – tube gland

Material / material: Messing / brass

| Typ   | Rohr- $\phi$ | Abmessungen mm |     | Innen- $\phi$ mm  | VPE  | ArtNr    | €/Stk. |
|-------|--------------|----------------|-----|-------------------|------|----------|--------|
| type  | tube- $\phi$ | CH1            | CH2 | P                 | Stk. |          |        |
|       |              | dimensions mm  |     | inside- $\phi$ mm | PU   |          | /pc.   |
| ESG16 | 16           | 22             | 24  | 14,0              | 20   | 32-ESG16 | 6,00   |
| ESG20 | 20           | 26             | 28  | 18,0              | 20   | 32-ESG20 | 7,44   |
| ESG25 | 25           | 32             | 34  | 22,5              | 10   | 32-ESG25 | 11,38  |
| ESG32 | 32           | 40             | 42  | 29,5              | 10   | 32-ESG32 | 14,47  |
| ESG40 | 40           | 47             | 50  | 37,5              | 5    | 32-ESG40 | 20,66  |
| ESG50 | 50           | 60             | 61  | 47,0              | 5    | 32-ESG50 | 28,56  |
| ESG60 | 60           | 71             | 74  | 56,0              | 2    | 32-ESG60 | 45,13  |

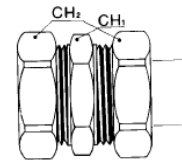

## GOGACON CM schnell schließende Rohr - Schlauch Verschr. / quick-locking tube-conduit gland

Passende Schläuche auf Anfrage / suitable conduits upon request

Material / material: Messing / brass

| Typ     | Rohr- $\phi$ | Schlauch-            | Abmessungen mm |     |     | Innen- $\phi$ mm  | VPE  | ArtNr      | €/Stk. |
|---------|--------------|----------------------|----------------|-----|-----|-------------------|------|------------|--------|
| type    | tube- $\phi$ | Nennweite mm         | CH1            | CH2 | CH3 | P                 | Stk. |            |        |
|         |              | conduit nominal size | dimensions mm  |     |     | inside- $\phi$ mm | PU   |            |        |
| CMFR161 | 16           | 9                    | 22             | 24  | 22  | 7,0               | 20   | 32-CMFR161 | 6,66   |
| CMFR162 | 16           | 10                   | 22             | 24  | 24  | 8,5               | 20   | 32-CMFR162 | 7,40   |
| CMFR163 | 16           | 12                   | 24             | 24  | 26  | 10,5              | 20   | 32-CMFR163 | 6,64   |
| CMFR16  | 16           | 15                   | 28             | 24  | 30  | 14,0              | 20   | 32-CMFR16  | 7,23   |
| CMFR20  | 20           | 15                   | 28             | 28  | 30  | 14,0              | 20   | 32-CMFR20  | 7,98   |
| CMFR20A | 20           | 20                   | 35             | 28  | 38  | 18,0              | 10   | 32-CMFR20A | 11,02  |
| CMFR25  | 25           | 20                   | 35             | 34  | 38  | 18,5              | 10   | 32-CMFR25  | 12,08  |
| CMFR25A | 25           | 25                   | 40             | 34  | 42  | 22,5              | 10   | 32-CMFR25A | 13,41  |
| CMFR25B | 25           | 27                   | 42             | 34  | 45  | 22,5              | 10   | 32-CMFR25B | 13,89  |
| CMFR32  | 32           | 27                   | 42             | 42  | 45  | 25,0              | 5    | 32-CMFR32  | 15,70  |
| CMFR32A | 32           | 33                   | 50             | 42  | 53  | 29,5              | 5    | 32-CMFR32A | 20,25  |
| CMFR32B | 32           | 35                   | 50             | 42  | 53  | 29,5              | 5    | 32-CMFR32B | 21,72  |
| CMFR40  | 40           | 33                   | 50             | 50  | 53  | 31,0              | 5    | 32-CMFR40  | 22,62  |
| CMFR40A | 40           | 35                   | 50             | 50  | 53  | 32,5              | 5    | 32-CMFR40A | 23,00  |
| CMFR40B | 40           | 40                   | 58             | 50  | 61  | 37,5              | 5    | 32-CMFR40B | 26,08  |
| CMFR50  | 50           | 50                   | 70             | 61  | 74  | 47,0              | 2    | 32-CMFR50  | 42,60  |
| CMFR50A | 50           | 40                   | 60             | 61  | 61  | 37,5              | 5    | 32-CMFR50A | 39,26  |
| CMFR60  | 60           | 65                   | 95             | 74  | 95  | 56,0              | 1    | 32-CMFR60  | 155,00 |
| CMFR60A | 60           | 50                   | 71             | 74  | 74  | 48,0              | 2    | 32-CMFR60A | 59,90  |

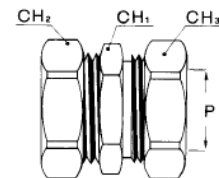

Preise gültig ab 01.07.2021 exkl. MwSt., freibleibend, Auftragsrabatt auf Anfrage / prices are valid from 01.07.2021 excl. VAT, subject to change, discounts upon request  
sonst. Konditionen siehe [www.gogatec.com/AGB.pdf](http://www.gogatec.com/AGB.pdf), techn. Änderungen vorbehalten / terms & conditions can be found on our website: [www.gogatec.com/AGB.pdf](http://www.gogatec.com/AGB.pdf); error, technical modifications and variations are reserved

Neben der guten Verbindung der Verschraubung und dem Rohr, ist es auch notwendig eine hohe Festigkeit und Isolierung im Falle einer Beanspruchung oder ruckartigen Bewegung zu gewährleisten. / As well as secure anchoring of the gland and the tube, it is also necessary to guarantee solidity and insulation for the electric continuity of the couple.

Die sichere Fixierung der Verschraubung mit dem Rohr ist garantiert und unterscheidet sich in ihrer Effizienz weitgehend von den anderen ES-Verschraubungen. Der Dichtgummi verhindert das Eindringen von Wasser und Staub und gewährleistet somit eine Schutzart von IP67 und einen mechanischen Schutz gegen Stöße etc. /

The secure connection of gland and tube is guaranteed by the efficiency that distinguishes all the fitments in the AR range and further by the special plasticised pressure washer which assures the couple impermeable both to water and dust and provides mechanical protection against jerks and traction on the pipe itself.



## GOGACON ESPR Kombinierte Rohr- / Kabelverschraubung / combined tube-/conduit gland

Material / material: Messing / brass

| Typ<br>type | Kabel-Ø mm<br>cable-Ø mm |      | Rohr-Ø<br>tube-Ø | Gewinde<br>F<br>thread | Abwechslung mm<br>dimensions mm |     |     | VPE<br>Stk.<br>PU | ArtNr       | €/Stk.<br>/pc. |
|-------------|--------------------------|------|------------------|------------------------|---------------------------------|-----|-----|-------------------|-------------|----------------|
|             | von                      | bis  |                  |                        | CH1                             | CH2 | CH3 |                   |             |                |
| ESPR1606    | 4,0                      | 6,5  | 16               | 1/2"                   | 24                              | 22  | 24  | 20                | 32-ESPR1606 | 9,84           |
| ESPR1608    | 5,0                      | 8,0  | 16               |                        | 24                              | 22  | 24  | 20                | 32-ESPR1608 | 9,84           |
| ESPR1609    | 6,5                      | 9,5  | 16               |                        | 24                              | 22  | 24  | 20                | 32-ESPR1609 | 9,84           |
| ESPR1610    | 7,0                      | 10,5 | 16               |                        | 24                              | 22  | 24  | 20                | 32-ESPR1610 | 9,84           |
| ESPR1613    | 9,0                      | 13,0 | 16               |                        | 24                              | 22  | 24  | 20                | 32-ESPR1613 | 9,84           |
| ESPR2011    | 7,0                      | 10,5 | 20               |                        | 24                              | 26  | 28  | 20                | 32-ESPR2011 | 11,80          |
| ESPR2013    | 7,0                      | 13,0 | 20               | 24                     | 26                              | 28  | 20  | 32-ESPR2013       | 12,02       |                |
| ESPR2016    | 11,5                     | 15,5 | 20               | 24                     | 26                              | 28  | 20  | 32-ESPR2016       | 11,80       |                |
| ESPR2018    | 14,0                     | 18,0 | 20               | 3/4"                   | 30                              | 30  | 28  | 20                | 32-ESPR2018 | 15,20          |
| ESPR2518    | 14,0                     | 18,0 | 25               |                        | 30                              | 32  | 34  | 10                | 32-ESPR2518 | 17,21          |
| ESPR2520    | 17,0                     | 20,5 | 25               |                        | 30                              | 32  | 34  | 10                | 32-ESPR2520 | 17,21          |
| ESPR3225    | 21,0                     | 25,0 | 32               | 1"                     | 38                              | 40  | 42  | 10                | 32-ESPR3225 | 20,55          |
| ESPR4032    | 27,0                     | 32,0 | 40               | 1" 1/2"                | 50                              | 50  | 50  | 1                 | 32-ESPR4032 | 36,98          |
| ESPR4034    | 29,0                     | 34,0 | 40               |                        | 50                              | 50  | 50  | 1                 | 32-ESPR4034 | 36,98          |
| ESPR4036    | 32,0                     | 36,0 | 40               |                        | 50                              | 50  | 50  | 1                 | 32-ESPR4036 | 36,98          |
| ESPR5036    | 32,0                     | 36,0 | 50               |                        | 50                              | 58  | 61  | 1                 | 32-ESPR5036 | 52,50          |
| ESPR5043    | 39,0                     | 43,0 | 50               | 2"                     | 64                              | 64  | 61  | 1                 | 32-ESPR5043 | 88,90          |

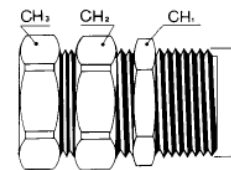

Preise gültig ab 01.07.2021 exkl. MwSt., freibleibend, Auftragsrabatt auf Anfrage / prices are valid from 01.07.2021 excl. VAT, subject to change, discounts upon request  
sonst. Konditionen siehe [www.gogatec.com/AGB.pdf](http://www.gogatec.com/AGB.pdf), techn. Änderungen vorbehalten / terms & conditions can be found on our website: [www.gogatec.com/AGB.pdf](http://www.gogatec.com/AGB.pdf); error, technical modifications and variations are reserved

FIM/G Edelstahl-Rohrverschraubungen erlauben die sehr rasche Verbindung mit Edelstahl Röhren und gewährleisten ein hohes Maß an Schutz. Sie sind preiswert und leicht zu montieren. Sie werden in allen Gebieten wo eine hohe Beständigkeit gegen raue Bedingungen, z.B. Autobahnen, Züge/Tunnel, Chemie-/Petrochemie-/Pharmazeutik- und Lebensmittelindustrie vorausgesetzt werden. /

FIM quick fit fittings allow the connection with stainless steel pipes and ensures an high degree of protection. FIM fittings are cheap and easy to install. They are particularly suitable for harsh environment installation where a high resistance of the material is required: highways and railways (incl. tunnels), chemical and petrochemical, farmaceutical, food industry sectors.

Material / material: Edelstahl AISI 316L / stainless steel AISI 316L

Schutzklasse / protection grade: IP67

Zertifizierung / certification: CEI EN 61386 - 2005-04

Eigenschaften / properties: beständig gegen Chemikalien und alle Wetterbedingungen / resistance to chemicals and wheatering, verbesserte mechanische Festigkeit / enhanced mechanical strength, verbesserte Brennbarkeitsklasse / enhanced flame class

### GOGACON FIM Edelstahl-Rohrverschraubung Außengewinde / stainless steel pipe gland outside thread

| Typ          | Gewinde | Rohr-Ø        | Gewindel. A   | Innen-Ø B       | Außen-Ø OD1      | Gesamtl.     | SW SP1      | VPE | ArtNr           | €          |
|--------------|---------|---------------|---------------|-----------------|------------------|--------------|-------------|-----|-----------------|------------|
| type         | thread  | pipe diameter | thread length | inside diameter | outside diameter | total length | wrench size | PU  |                 | /Stk. /pc. |
| FIM16M16X316 | M16     | 16            | 10            | 11,5            | 27,0             | 32,0         | 24          | 20  | 32-FIM16M16X316 | 22,85      |
| FIM20M20X316 | M20     | 20            | 10            | 11,5            | 30,0             | 32,0         | 33          | 20  | 32-FIM20M20X316 | 32,94      |
| FIM25M25X316 | M25     | 25            | 10            | 20,5            | 39,0             | 3,0          | 36          | 10  | 32-FIM25M25X316 | 34,29      |
| FIM32M32X316 | M32     | 32            | 14            | 27,0            | 45,0             | 38,5         | 41          | 10  | 32-FIM32M32X316 | 45,90      |
| FIM40M40X316 | M40     | 40            | 15            | 35,0            | 56,5             | 44,5         | 50          | 5   | 32-FIM40M40X316 | 65,20      |
| FIM50M50X316 | M50     | 50            | 15            | 45,0            | 68,0             | 45,0         | 60          | 5   | 32-FIM50M50X316 | 81,40      |

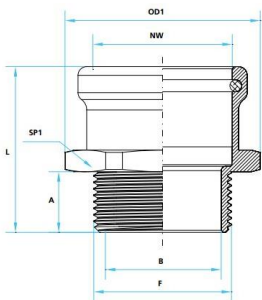

### GOGACON FIG Edelstahl Rohr-Rohr-Verbinder / stainless steel pipe to pipe connector

| Typ       | Rohr-Ø        | Innen-Ø B       | Außen-Ø OD1      | Gesamtl.     | VPE | ArtNr        | €          |
|-----------|---------------|-----------------|------------------|--------------|-----|--------------|------------|
| type      | pipe diameter | inside diameter | outside diameter | total length | PU  |              | /Stk. /pc. |
| FIG16X316 | 16            | 14,0            | 23,0             | 42,0         | 20  | 32-FIG16X316 | 23,66      |
| FIG20X316 | 20            | 18,0            | 27,6             | 42,0         | 20  | 32-FIG20X316 | 32,25      |
| FIG25X316 | 25            | 22,5            | 32,6             | 44,0         | 20  | 32-FIG25X316 | 34,06      |
| FIG32X316 | 32            | 29,5            | 39,0             | 47,0         | 10  | 32-FIG32X316 | 42,13      |
| FIG40X316 | 40            | 37,5            | 50,0             | 57,5         | 5   | 32-FIG40X316 | 64,90      |
| FIG50X316 | 50            | 47,5            | 59,7             | 57,5         | 2   | 32-FIG50X316 | 91,00      |

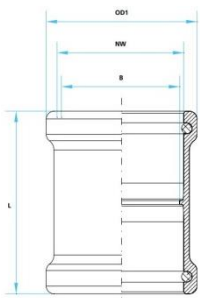

Preise gültig ab 01.07.2021 exkl. MwSt., freibleibend, Auftragsrabatt auf Anfrage /

prices are valid from 01.07.2021 excl. VAT, subject to change, discounts upon request

sonst. Konditionen siehe [www.gogatec.com/AGB.pdf](http://www.gogatec.com/AGB.pdf), techn. Änderungen vorbehalten /

terms & conditions can be found on our website: [www.gogatec.com/AGB.pdf](http://www.gogatec.com/AGB.pdf); error, technical modifications and variations are reserved